

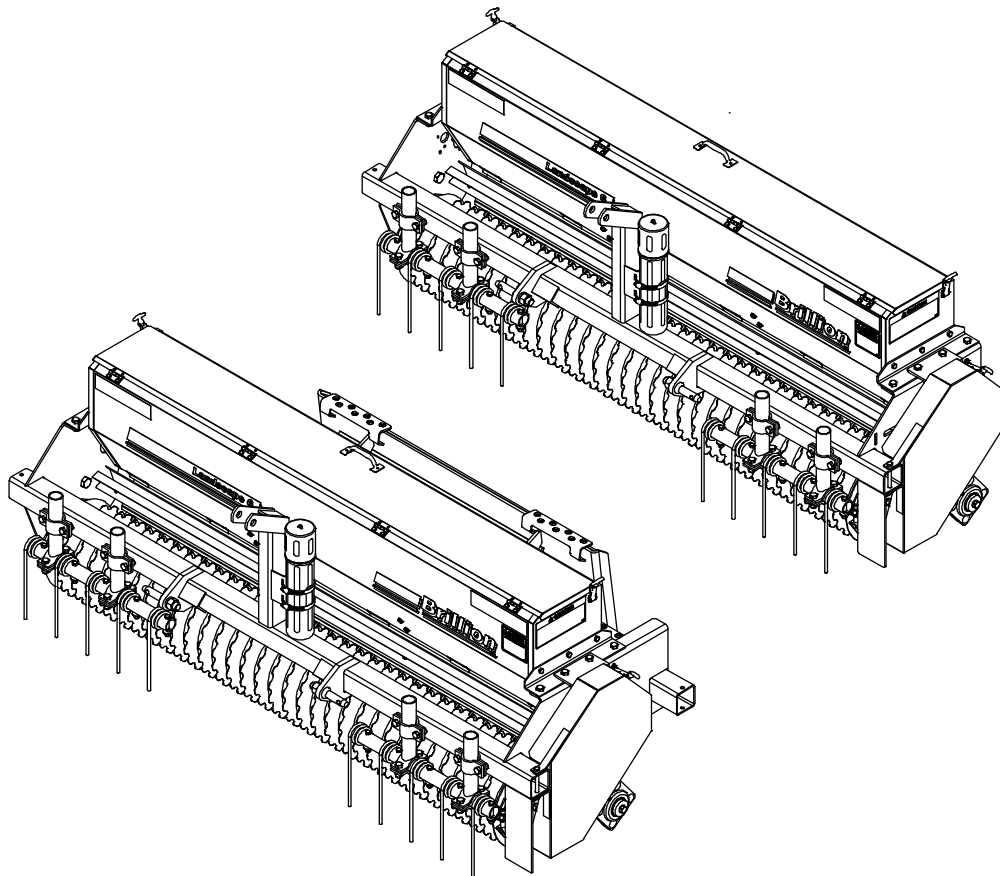

Landscaper Grass Seeder Models LSP5, LSP6 and LSS6 Operator's Manual



LANDOLL CORPORATION

1900 North Street
Marysville, Kansas 66508
(785) 562-5381

800-428-5655 ~ WWW.LANDOLL.COM

Table of Contents

1 Safety Information

Introduction	1-1
Description of Unit	1-1
Using this Manual	1-1
Owner Assistance	1-1
Warranty Registration	1-1
Understanding Safety Statements	1-2
Transporting Safety	1-3
Attaching, Detaching, Storage	1-3
Maintenance Safety	1-3
Protective Equipment	1-3
Chemical Safety	1-3
Prepare for Emergencies	1-3
Safety Signs	1-4

2 Operation

Landscape Seeder Operation	2-1
Attaching to a Tractor	2-2
Seed Rate Adjustment-Adjusting the Box Slide	2-3
Calibration of the Seed Box	2-4
Planting Rates for Seed Box	2-4
Doubling the Seed Rate	2-5
Acre Meter (Optional)	2-6
Settings for Loup Acre Meters After 05/15/2012	2-6
Field Acres	2-6
Total Acres	2-6
Pulses Per 400 Feet	2-6
Width	2-6
Password	2-6
Changing The Password	2-7
Quick-start Settings for Loup Acre Meters Prior to 05/15/2012	2-7
To Program Meter	2-7
To Enter Password	2-7
To Disable Password	2-7
Battery Replacement	2-7
Adjustment of Wheel Track Remover	2-10

3 Assembly Of Optional Equipment

Agitator Blades (Optional Cage or Brushes) 3-1
Changing Agitator Kits 3-1
Lift Sling Kit (Optional) 3-3
Acre Meter Kit 6K036 Installation 3-4

4 Maintenance

General Torque Specifications 4-1
Fasteners 4-2
Acre Meter 4-2
Lubrication 4-2
Chain Tension 4-3
Roller Wheels 4-3
Maintenance Chart 4-4

5 Specifications

Safety Information

Introduction

The implement described in this manual has been designed with care and built by skilled workers using quality materials and processes. Proper assembly, maintenance and safe operation will allow this machine to provide you with satisfactory use for seasons to come.



DANGER

Read this entire manual before attempting to assemble, adjust or operate this machine. Failure to comply with this warning can result in personal injury or death, damage to the machine or its components and inferior operation.

Description of Unit

The LSP Landscape Seeder is the latest addition to the Brillion lineup of landscape turfmaker seeders. With its single landscape style box that is equipped with the polyethylene blade type agitator, this unit can handle most turf seeds with ease. Built on a structural tube mainframe, this seeder provides increased seed box capacity and a simplified roller chain drive system. The seeder roller assemblies have greaseable, flange style, self aligning bearings. The integral Cat. 1 3-point hitch provides for a close coupled unit that compliments the new generation of compact tractors very well.

The Brillion LSS6 Skid Steer Landscape Seeder, new to the Landscape Seeder lineup, is a bi-directional seeder with a three point hitch that can be attached to the front or rear of the seeder frame. A skid steer quick-attach mounting plate is standard equipment. Depending on the choice of mounting, the seeder can be either pushed or pulled by the skid steer. In addition, the seeder will also mount to tractors with a standard Cat. 1 three point hitch.

The machine shown in the following illustrations may not directly match with your unit. Your assembled machine, however, is similar for all models. Additional parts identification and location can be obtained by reviewing the parts catalog 7K457.

Using this Manual

This manual will familiarize you with safety, assembly, operation, adjustment, and maintenance. Read this manual and follow the recommendations to help ensure safe and efficient operation.

- The information in this manual is current at time of printing. Some parts may change to assure top performance.
- Location reference: Right and Left designations in this manual are determined by facing the direction the machine will travel during field operation, unless otherwise stated.

Owner Assistance

If customer service or repairs are needed, contact your Brillion dealer. They have trained personnel, parts and service equipment specially designed for Brillion products. Your machine's parts should only be replaced with Brillion parts. Have the Serial Number and complete Model Number available when ordering parts from your Brillion dealer. **See Figure 1-1.**

Warranty Registration

Brillion Farm Equipment, by Landoll, shall have no warranty obligation unless each product is registered, within 10 days of retail purchase, using the Landoll Corporation Ag Products on-line registration process. Please refer to the Ag Products Policy and Procedures Manual, accessible at www.landoll.com for step by step instructions regarding product registration.

Enter your product information below for quick reference.

MODEL NUMBER _____

SERIAL NUMBER _____

DATE OF PURCHASE _____

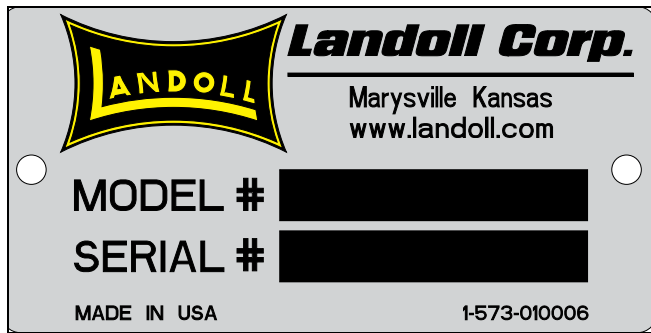

Figure 1-1: ID Plate

Federal law requires that you explain the safety and operating instructions furnished with this machine to all operators before they are allowed to operate the machine. These instructions must be repeated to the operators at the beginning of each season. Be sure to observe and follow the instructions for the safety of anyone operating or near the machine.

NOTE

Investigation has shown that nearly 1/3 of all farm accidents are caused by careless use of machinery. Insist that all people working with you or for you abide by all safety instructions.

Understanding Safety Statements

NOTICE

Special notice - read and thoroughly understand.



CAUTION

Proceed with caution. Failure to heed caution may cause injury to person or damage product.



WARNING

Proceed with caution. Failure to heed warning will cause injury to person or damage product.



DANGER

Proceed with extreme caution. Failure to heed notice will cause injury or death to person and/or damage product.

NOTE

You should read and understand the information contained in this manual and on the machine decals before you attempt to operate or maintain this equipment.

- **Examine safety decals and be sure you have the correct safety decals for the machine. See Safety Sign and Locations in Safety Section for decal locations, See Figures 1-2 and 1-3 for reference. Order replacement decals through your Brillion dealer.**
- Keep these signs clean so they can be observed readily. It is important to keep these decals cleaned more frequently than the machine. Wash with soap and water or a cleaning solution as required.
- Replace decals that become damaged or lost. Also, be sure that any new machine components installed during repair include decals which are assigned to them by the manufacturer.
- When applying decals to the machine, be sure to clean the surface to remove any dirt or residue. Where possible, sign placement should protect the sign from abrasion, damage, or obstruction from mud, dirt, oil etc.

**DANGER**

- **Keep Riders Off of Machinery**
Do not allow anyone to ride on tractor or machine. Riders could be struck by foreign objects or thrown from the machine.
- **Never allow children to operate equipment.**
- **Keep bystanders away from machine during operation.**

Transporting Safety

IMPORTANT

It is the responsibility of the owner/operator to comply with all state and local laws.

- When transporting the machine on a road or highway, use adequate warning symbols, reflectors, lights and slow moving vehicle sign as required. Slow moving tractors and towed implements can create a hazard when driven on public roads. They are difficult to see, especially at night.
- Do not tow an implement that, when fully loaded, weighs more than 1.5 times the weight of the towing vehicle.
- Carry reflectors or flags to mark the tractor and implement in case of breakdown on the road.
- Do not transport at speeds over 20 MPH under good conditions. Never travel at a speed which does not allow adequate control of steering and stopping. Reduce speed if towed load is not equipped with brakes.
- Avoid sudden stops or turns because the weight of the machine may cause the operator to lose control of the tractor. Use a tractor heavier than the machine.
- Use caution when towing behind articulated steering tractors; fast or sharp turns may cause the machine to shift sideways.
- Keep clear of overhead power lines and other obstructions when transporting. Know transport height and width of your machine.

Attaching, Detaching, Storage

- Do not stand between the tractor and implement when attaching or detaching implement unless both are prevented from moving.

Maintenance Safety

- Block the machine so it will not roll when working on or under it to prevent injury in case of hydraulic failure or inadvertent lowering by another person.
- Do not make adjustments or lubricate machine while it is in motion.
- Make sure all moving parts have stopped and all system pressure is relieved.
- Keep all guards in place. Replace any that become damaged.
- Understand the procedure before doing the work. Use proper tools and equipment.

NOTES

On most tractors relieving hydraulic pressure can be accomplished by operating valves after the engine is stopped. Also, the machine should be lowered to ground so that the shanks are taking the load.

Wear protective gloves and safety glasses or goggles when working with hydraulic systems.

Protective Equipment

- Wear protective clothing and equipment.
- Wear clothing and equipment appropriate for the job. Avoid loose fitting clothing.
- Because prolonged exposure to loud noise can cause hearing impairment or hearing loss, wear suitable hearing protection, such as earmuffs or earplugs.

Chemical Safety

- Agricultural chemicals can be dangerous. Improper use can seriously injure persons, animals, plants, soil and property.
- Read chemical manufactures instructions and store or dispose of unused chemicals as specified.
- Handle chemicals with care and avoid inhaling smoke from any type of chemical fire.
- Store or dispose of unused chemicals as specified by the chemical manufacturer.

Prepare for Emergencies

- Keep a First Aid Kit and Fire Extinguisher handy.
- Keep emergency numbers for doctor, ambulance, hospital and fire department near phone.

Safety Signs

WARNING

MOVING PART HAZARD

TO PREVENT SERIOUS INJURY FROM MOVING PARTS:

- KEEP COVERS CLOSED DURING OPERATION.
- DO NOT ALLOW ANYONE TO RIDE OR CLIMB MACHINE DURING OPERATION.
- KEEP OBSERVERS AWAY.

2K123

1

CAUTION

1. DO NOT LUBRICATE, ADJUST OR REPAIR WHEN MACHINE IS IN MOTION.
2. DO NOT TOW OR TRANSPORT FASTER THAN 15 MILES PER HOUR.
3. DO NOT RIDE OR ALLOW OTHERS TO RIDE ON THE MACHINE.
4. BLOCK UP ALL HYDRAULICALLY OR MECHANICALLY RAISED COMPONENTS TO PREVENT UNINTENDED LOWERING OR LOWER THE MACHINE TO THE GROUND TO MAKE ADJUSTMENT OR REPAIRS OR WHEN NOT IN USE.
5. KEEP ALL PERSONS AWAY FROM MACHINE DURING HITCHING AND OPERATING.
6. SLOW DOWN BEFORE MAKING SHARP TURNS OR USING THE BRAKE.
7. DRIVE SLOWLY OVER ROUGH GROUND, SIDE HILLS, AND AROUND CURVES TO AVOID TIPPING.
8. COMPLY WITH ALL LAWS WHEN TRANSPORTING THE MACHINE ON PUBLIC ROADWAYS.
9. INSTRUCT ALL OPERATORS IN THE SAFE OPERATION OF THE MACHINE. REVIEW THE OPERATOR'S MANUAL FOR CORRECT PROCEDURES.
10. BLOCK IMPLEMENT TO PREVENT MOVEMENT WHEN UNHITCHED FROM TRACTOR.
10. KEEP ALL GUARDS AND SHIELDS IN PLACE WHILE MACHINE OR PARTS ARE IN MOTION.

8J310

2

IMPORTANT

DISENGAGE CLUTCH (IF SO EQUIPPED) OR RAISE SEEDER BEFORE BACKING UP. FAILURE TO DO SO WILL DAMAGE BRUSH AGITATORS.

5D505

4

CAUTION

BE SURE TO ENGAGE PARKING PIN ON LEFT END OF FRAME BEFORE UNHITCHING TRACTOR. OTHERWISE FRAME WILL TIP BACKWARDS ABOUT FRONT AXLE

9J302

3

PARKING PIN

9J301

7



5



6



11

CALIBRATION OF SEED BOX

SEED BOX MAY BE CALIBRATED FOR SELECTED SEEDS AS FOLLOWS:

1. RAISE MACHINE AND LOCK IN TRANSPORT POSITION.
2. PLACE A WEIGHING PAN ON COLLECT TRUCK.
3. TURN THE SELECT SWITCH TO THE WEIGHING POSITION.
4. WEIGH SEED AND MULTIPLY BY 30 OR FOR 16 TOOTH DRIVER FOR APPROXIMATE PLANTING RATE IN POUNDS PER ACRE.

PLANTING RATES FOR SEED BOX

1. RATES ARE FOR 13 TOOTH DRIVER. DOUBLE THESE VALUES FOR 20 TOOTH DRIVER.

2. RATES ARE BASED ON 4 SEEDS PER 1000 SQUARE INCHES AND CLEARENESS WILL AFFECT RATES. CHECK AIRFLOW AND POUNDS OF SEED USED FOR BEST RESULTS.

	SEEDER EQUIPPED WITH BRUSH AGITATORS					SEEDER EQUIPPED WITH PLASTIC BLADE AGITATORS				
	POUNDS PER ACRE					POUNDS PER 1000 SQ. FT.				
INDICATOR SETTINGS	0	1	2	3	4	1	2	3	4	5
WEIGHT RECOMMENDATION	30	60	90	120	150	12	24	36	48	60
WEIGHT RECOMMENDATION	20	40	60	80	100	8	16	24	32	40
WEIGHT RECOMMENDATION	100	200	300	400	500	40	80	120	160	200
WEIGHT RECOMMENDATION	200	400	600	800	1000	80	160	240	320	400
WEIGHT RECOMMENDATION	300	600	900	1200	1500	120	240	360	480	600
WEIGHT RECOMMENDATION	400	800	1200	1600	2000	160	320	480	640	800
WEIGHT RECOMMENDATION	500	1000	1500	2000	2500	200	400	600	800	1000
WEIGHT RECOMMENDATION	600	1200	1800	2400	3000	240	480	720	960	1200
WEIGHT RECOMMENDATION	700	1400	2100	2800	3500	280	560	840	1120	1400
WEIGHT RECOMMENDATION	800	1600	2400	3200	4000	320	640	960	1280	1600
WEIGHT RECOMMENDATION	900	1800	2700	3600	4500	360	720	1080	1440	1800
WEIGHT RECOMMENDATION	1000	2000	3000	4000	5000	400	800	1200	1600	2000

SEEDER EQUIPPED WITH BRUSH AGITATORS

WEIGHT RECOMMENDATION: 30 60 90 120 150

WEIGHT RECOMMENDATION: 20 40 60 80 100

WEIGHT RECOMMENDATION: 100 200 300 400 500

WEIGHT RECOMMENDATION: 200 400 600 800 1000

WEIGHT RECOMMENDATION: 300 600 900 1200 1500

WEIGHT RECOMMENDATION: 400 800 1200 1600 2000

WEIGHT RECOMMENDATION: 500 1000 1500 2000 2500

WEIGHT RECOMMENDATION: 600 1200 1800 2400 3000

WEIGHT RECOMMENDATION: 700 1400 2100 2800 3500

WEIGHT RECOMMENDATION: 800 1600 2400 3200 4000

WEIGHT RECOMMENDATION: 900 1800 2700 3600 4500

WEIGHT RECOMMENDATION: 1000 2000 3000 4000 5000

SEEDER EQUIPPED WITH PLASTIC BLADE AGITATORS

WEIGHT RECOMMENDATION: 12 24 36 48 60

WEIGHT RECOMMENDATION: 8 16 24 32 40

WEIGHT RECOMMENDATION: 40 80 120 160 200

WEIGHT RECOMMENDATION: 80 160 240 320 400

WEIGHT RECOMMENDATION: 120 240 360 480 600

WEIGHT RECOMMENDATION: 160 320 480 640 800

WEIGHT RECOMMENDATION: 200 400 600 800 1000

WEIGHT RECOMMENDATION: 240 480 720 960 1200

WEIGHT RECOMMENDATION: 280 560 840 1120 1400

WEIGHT RECOMMENDATION: 320 640 960 1280 1600

WEIGHT RECOMMENDATION: 360 720 1080 1440 1800

WEIGHT RECOMMENDATION: 400 800 1200 1600 2000

WEIGHT RECOMMENDATION: 480 960 1440 1920 2400

WEIGHT RECOMMENDATION: 560 1120 1680 2240 2800

WEIGHT RECOMMENDATION: 640 1280 1920 2560 3200

WEIGHT RECOMMENDATION: 720 1440 2160 2880 3600

WEIGHT RECOMMENDATION: 800 1600 2400 3200 4000

WEIGHT RECOMMENDATION: 880 1760 2640 3520 4400

WEIGHT RECOMMENDATION: 960 1920 2880 3840 4800

WEIGHT RECOMMENDATION: 1040 2080 3120 4160 5200

WEIGHT RECOMMENDATION: 1120 2240 3360 4480 5600

WEIGHT RECOMMENDATION: 1200 2400 3600 4800 6000

WEIGHT RECOMMENDATION: 1280 2560 3840 5120 6400

WEIGHT RECOMMENDATION: 1360 2720 4080 5440 6800

WEIGHT RECOMMENDATION: 1440 2880 4320 5760 7200

WEIGHT RECOMMENDATION: 1520 3040 4560 6080 7600

WEIGHT RECOMMENDATION: 1600 3200 4800 6400 8000

WEIGHT RECOMMENDATION: 1680 3360 5040 6720 8400

WEIGHT RECOMMENDATION: 1760 3520 5280 7040 8800

WEIGHT RECOMMENDATION: 1840 3680 5520 7360 9200

WEIGHT RECOMMENDATION: 1920 3840 5760 7680 9600

WEIGHT RECOMMENDATION: 2000 4000 6000 8000 10000

WEIGHT RECOMMENDATION: 2080 4160 6240 8320 10400

WEIGHT RECOMMENDATION: 2160 4320 6480 8640 10800

WEIGHT RECOMMENDATION: 2240 4480 6720 8960 11200

WEIGHT RECOMMENDATION: 2320 4640 6960 9280 11600

WEIGHT RECOMMENDATION: 2400 4800 7200 9600 12000

WEIGHT RECOMMENDATION: 2480 4960 7440 9920 12400

WEIGHT RECOMMENDATION: 2560 5120 7680 10240 12800

WEIGHT RECOMMENDATION: 2640 5280 7920 10560 13200

WEIGHT RECOMMENDATION: 2720 5440 8160 10880 13600

WEIGHT RECOMMENDATION: 2800 5600 8400 11200 14000

WEIGHT RECOMMENDATION: 2880 5760 8640 11520 14400

WEIGHT RECOMMENDATION: 2960 5920 8880 11840 14800

WEIGHT RECOMMENDATION: 3040 6080 9120 12160 15200

WEIGHT RECOMMENDATION: 3120 6240 9360 12480 15600

WEIGHT RECOMMENDATION: 3200 6400 9600 12800 16000

WEIGHT RECOMMENDATION: 3280 6560 9840 13120 16400

WEIGHT RECOMMENDATION: 3360 6720 10080 13440 16800

WEIGHT RECOMMENDATION: 3440 6880 10320 13760 17200

WEIGHT RECOMMENDATION: 3520 7040 10560 14080 17600

WEIGHT RECOMMENDATION: 3600 7200 10800 14400 18000

WEIGHT RECOMMENDATION: 3680 7360 11040 14720 18400

WEIGHT RECOMMENDATION: 3760 7520 11280 15040 18800

WEIGHT RECOMMENDATION: 3840 7680 11520 15360 19200

WEIGHT RECOMMENDATION: 3920 7840 11760 15680 19600

WEIGHT RECOMMENDATION: 4000 8000 12000 16000 20000

WEIGHT RECOMMENDATION: 4080 8160 12240 16320 20400

WEIGHT RECOMMENDATION: 4160 8320 12480 16640 20800

WEIGHT RECOMMENDATION: 4240 8480 12720 16960 21200

WEIGHT RECOMMENDATION: 4320 8640 12960 17280 21600

WEIGHT RECOMMENDATION: 4400 8800 13200 17600 22000

WEIGHT RECOMMENDATION: 4480 8960 13440 17920 22400

WEIGHT RECOMMENDATION: 4560 9120 13680 18240 22800

WEIGHT RECOMMENDATION: 4640 9280 13920 18560 23200

WEIGHT RECOMMENDATION: 4720 9440 14160 18880 23600

WEIGHT RECOMMENDATION: 4800 9600 14400 19200 24000

WEIGHT RECOMMENDATION: 4880 9760 14640 19520 24400

WEIGHT RECOMMENDATION: 4960 9920 14880 19840 24800

WEIGHT RECOMMENDATION: 5040 10080 15120 20160 25200

WEIGHT RECOMMENDATION: 5120 10240 15360 20480 25600

WEIGHT RECOMMENDATION: 5200 10400 15600 20800 26000

WEIGHT RECOMMENDATION: 5280 10560 15840 21120 26400

WEIGHT RECOMMENDATION: 5360 10720 16080 21440 26800

WEIGHT RECOMMENDATION: 5440 10880 16320 21760 27200

WEIGHT RECOMMENDATION: 5520 11040 16560 22080 27600

WEIGHT RECOMMENDATION: 5600 11200 16800 22400 28000

WEIGHT RECOMMENDATION: 5680 11360 17040 22720 28400

WEIGHT RECOMMENDATION: 5760 11520 17280 23040 28800

WEIGHT RECOMMENDATION: 5840 11680 17520 23360 29200

WEIGHT RECOMMENDATION: 5920 11840 17760 23680 29600

WEIGHT RECOMMENDATION: 6000 12000 18000 24000 30000

WEIGHT RECOMMENDATION: 6080 12160 18240 24320 30400

WEIGHT RECOMMENDATION: 6160 12320 18480 24640 30800

WEIGHT RECOMMENDATION: 6240 12480 18720 24960 31200

WEIGHT RECOMMENDATION: 6320 12640 18960 25280 31600

WEIGHT RECOMMENDATION: 6400 12800 19200 25600 32000

WEIGHT RECOMMENDATION: 6480 12960 19440 25920 32400

WEIGHT RECOMMENDATION: 6560 13120 19680 26240 32800

WEIGHT RECOMMENDATION: 6640 13280 19920 26560 33200

WEIGHT RECOMMENDATION: 6720 13440 20160 26880 33600

WEIGHT RECOMMENDATION: 6800 13600 20400 27200 34000

WEIGHT RECOMMENDATION: 6880 13760 20640 27520 34400

WEIGHT RECOMMENDATION: 6960 13920 20880 27840 34800

WEIGHT RECOMMENDATION: 7040 14080 21120 28160 35200

WEIGHT RECOMMENDATION: 7120 14240 21360 28480 35600

WEIGHT RECOMMENDATION: 7200 14400 21600 28800 36000

WEIGHT RECOMMENDATION: 7280 14560 21840 29120 36400

WEIGHT RECOMMENDATION: 7360 14720 22080 29440 36800

WEIGHT RECOMMENDATION: 7440 14880 22320 29760 37200

WEIGHT RECOMMENDATION: 7520 15040 22560 30080 37600

WEIGHT RECOMMENDATION: 7600 15200 22800 30400 38000

WEIGHT RECOMMENDATION: 7680 15360 23040 30720 38400

WEIGHT RECOMMENDATION: 7760 15520 23280 31040 38800

WEIGHT RECOMMENDATION: 7840 15680 23520 31360 39200

WEIGHT RECOMMENDATION: 7920 15840 23760 31680 39600

WEIGHT RECOMMENDATION: 8000 16000 24000 32000 40000

WEIGHT RECOMMENDATION: 8080 16160 24240 32320 40400

WEIGHT RECOMMENDATION: 8160 16320 24480 32640 40800

WEIGHT RECOMMENDATION: 8240 16480 24720 32960 41200

WEIGHT RECOMMENDATION: 8320 16640 24960 33280 41600

WEIGHT RECOMMENDATION: 8400 16800 25200 33600 42000

WEIGHT RECOMMENDATION: 8480 16960 25440 33920 42400

WEIGHT RECOMMENDATION: 8560 17120 25680 34240 42800

WEIGHT RECOMMENDATION: 8640 17280 25920 34560 43200

WEIGHT RECOMMENDATION: 8720 17440 26160 34880 43600

WEIGHT RECOMMENDATION: 8800 17600 26400 35200 44000

WEIGHT RECOMMENDATION: 8880 17760 26640 35520 44400

WEIGHT RECOMMENDATION: 8960 17920 26880 35840 44800

WEIGHT RECOMMENDATION: 9040 18080 27120 36160 45200

WEIGHT RECOMMENDATION: 9120 18240 27360 36480 45600

WEIGHT RECOMMENDATION: 9200 18400 27600 36800 46000

WEIGHT RECOMMENDATION: 9280 18560 27840 37120 46400

WEIGHT RECOMMENDATION: 9360 18720 28080 37440 46800

WEIGHT RECOMMENDATION: 9440 18880 28320 37760 47200

WEIGHT RECOMMENDATION: 9520 19040 28560 38080 47600

WEIGHT RECOMMENDATION: 9600 19200 28800 38400 48000

WEIGHT RECOMMENDATION: 9680 19360 29040 38720 48400

WEIGHT RECOMMENDATION: 9760 19520 29280 39040 48800

WEIGHT RECOMMENDATION: 9840 19680 29520 39360 49200

WEIGHT RECOMMENDATION: 9920 19840 29760 39680 49600

WEIGHT RECOMMENDATION: 10000 20000 30000 40000 50000

WEIGHT RECOMMENDATION: 10080 20160 30240 40320 50400

WEIGHT RECOMMENDATION: 10160 20320 30480 40640 50800

WEIGHT RECOMMENDATION: 10240 20480 30720 40960 51200

WEIGHT RECOMMENDATION: 10320 20640 30960 41280 51600

WEIGHT RECOMMENDATION: 10400 20800 31200 41600 52000

WEIGHT RECOMMENDATION: 10480 20960 31440 41920 52400

WEIGHT RECOMMENDATION: 10560 21120 31680 42240 52800

WEIGHT RECOMMENDATION: 10640 21280 31920 42560 53200

WEIGHT RECOMMENDATION: 10720 21440 32160 42880 53600

WEIGHT RECOMMENDATION: 10800 21600 32400 43200 54000

WEIGHT RECOMMENDATION: 10880 21760 32640 43520 54400

WEIGHT RECOMMENDATION: 10960 21920 32880 43840 54800

WEIGHT RECOMMENDATION: 11040 22080 33120 44160 55200

WEIGHT RECOMMENDATION: 11120 22240 33360 44480 55600

WEIGHT RECOMMENDATION: 11200 22400 33600 44800 56000

WEIGHT RECOMMENDATION: 11280 22560 33840 45120 56400

WEIGHT RECOMMENDATION: 11360 22720 34080 45440 56800

WEIGHT RECOMMENDATION: 11440 22880 34320 45760 57200

WEIGHT RECOMMENDATION: 11520 23040 34560 46080 57600

WEIGHT RECOMMENDATION: 11600 23200 34800 46400 58000

WEIGHT RECOMMENDATION: 11680 23360 35040 46720 58400

WEIGHT RECOMMENDATION: 11760 23520 35280 47040 58800

WEIGHT RECOMMENDATION: 11840 23680 35520 47360 59200

WEIGHT RECOMMENDATION: 11920 23840 35760 47680 59600

WEIGHT RECOMMENDATION: 12000 24000 36000 48000 60000

WEIGHT RECOMMENDATION: 12080 24160 36240 48320 60400

WEIGHT RECOMMENDATION: 12160 24320 36480 48640 60800

WEIGHT RECOMMENDATION: 12240 24480 36720 48960 61200

WEIGHT RECOMMENDATION: 12320 24640 36960 49280 61600

WEIGHT RECOMMENDATION: 12400 24800 37200 49600 62000

WEIGHT RECOMMENDATION: 12480 24960 37440 49920 62400

WEIGHT RECOMMENDATION: 12560 25120 37680 50240 62800

WEIGHT RECOMMENDATION: 12640 25280 37920 50560 63200

WEIGHT RECOMMENDATION: 12720 25440 38160 50880 63600

WEIGHT RECOMMENDATION: 12800 25600 38400 51200 64000

WEIGHT RECOMMENDATION: 12880 25760 38640 51520 64400

WEIGHT RECOMMENDATION: 12960 25920 38880 51840 64800

WEIGHT RECOMMENDATION: 13040 26080 39120 52160 65200

WEIGHT RECOMMENDATION: 13120 26240 39360 52480 65600

WEIGHT RECOMMENDATION: 13200 26400 39600 52800 66000

WEIGHT RECOMMENDATION: 13280 26560 39840 53120 66400

WEIGHT RECOMMENDATION: 13360 26720 40080 53440 66800

WEIGHT RECOMMENDATION: 13440 26880 40320 53760 67200

WEIGHT RECOMMENDATION: 13520 27040 40560 54080 67600

WEIGHT RECOMMENDATION: 13600 27200 40800 54400 68000

WEIGHT RECOMMENDATION: 13680 27360 41040 54720 68400

WEIGHT RECOMMENDATION: 13760 27520 41280 55040 68800

WEIGHT RECOMMENDATION: 13840 27680 41520 55360 69200

WEIGHT RECOMMENDATION: 13920 27840 41760 55680 69600

WEIGHT RECOMMENDATION: 14000 28000 42000 56000 70000

WEIGHT RECOMMENDATION: 14080 28160 42240 56320 70400

WEIGHT RECOMMENDATION: 14160 28320 42480 56640 70800

WEIGHT RECOMMENDATION: 14240 28480 42720 56960 71200

WEIGHT RECOMMENDATION: 14320 28640 42960 57280 71600

WEIGHT RECOMMENDATION: 14400 28800 43200 57600 72000

WEIGHT RECOMMENDATION: 14480 28960 43440 57920 72400

WEIGHT RECOMMENDATION: 14560 29120 43680 58240 72800

WEIGHT RECOMMENDATION: 14640 29280 43920 58560 73200

WEIGHT RECOMMENDATION: 14720 29440 44160 58880 73600

WEIGHT RECOMMENDATION: 14800 29600 44400 59200 74000

WEIGHT RECOMMENDATION: 14880 29760 44640 59520 74400

WEIGHT RECOMMENDATION: 14960 29920 44880 59840 74800

WEIGHT RECOMMENDATION: 15040 30080 45120 60160 75200

WEIGHT RECOMMENDATION: 15120 30240 45360 60480 75600

WEIGHT RECOMMENDATION: 15200 30400 45600 60800 76000

WEIGHT RECOMMENDATION: 15280 30560 45840 61120 76400

WEIGHT RECOMMENDATION: 15360 30720 46080 61440 76800

WEIGHT RECOMMENDATION: 15440 30880 46320 61760 77200

WEIGHT RECOMMENDATION: 15520 31040 46560 62080 77600

WEIGHT RECOMMENDATION: 15600 31200 46800 62400 78000

WEIGHT RECOMMENDATION: 15680 31360 47040 62720 78400

WEIGHT RECOMMENDATION: 15760 31520 47280 63040 78800

WEIGHT RECOMMENDATION: 15840 31680 47520 63360 79200

WEIGHT RECOMMENDATION: 15920 31840 47760 63680 79600

WEIGHT RECOMMENDATION: 16000 32000 48000 64000 80000

WEIGHT RECOMMENDATION: 16080 32160 48240 64320 80400

WEIGHT RECOMMENDATION: 16160 32320 48480 64640 80800

WEIGHT RECOMMENDATION: 16240 32480 48720 64960 81200

WEIGHT RECOMMENDATION: 16320 32640 48960 65280 81600

WEIGHT RECOMMENDATION: 16400 32800 49200 65600 82000

WEIGHT RECOMMENDATION: 16480 32960 49440 65920 82400

WEIGHT RECOMMENDATION: 16560 33120 49680 66240 82800

WEIGHT RECOMMENDATION: 16640 33280 49920 66560 83200

WEIGHT RECOMMENDATION: 16720 33440 50160 66880 83600

WE

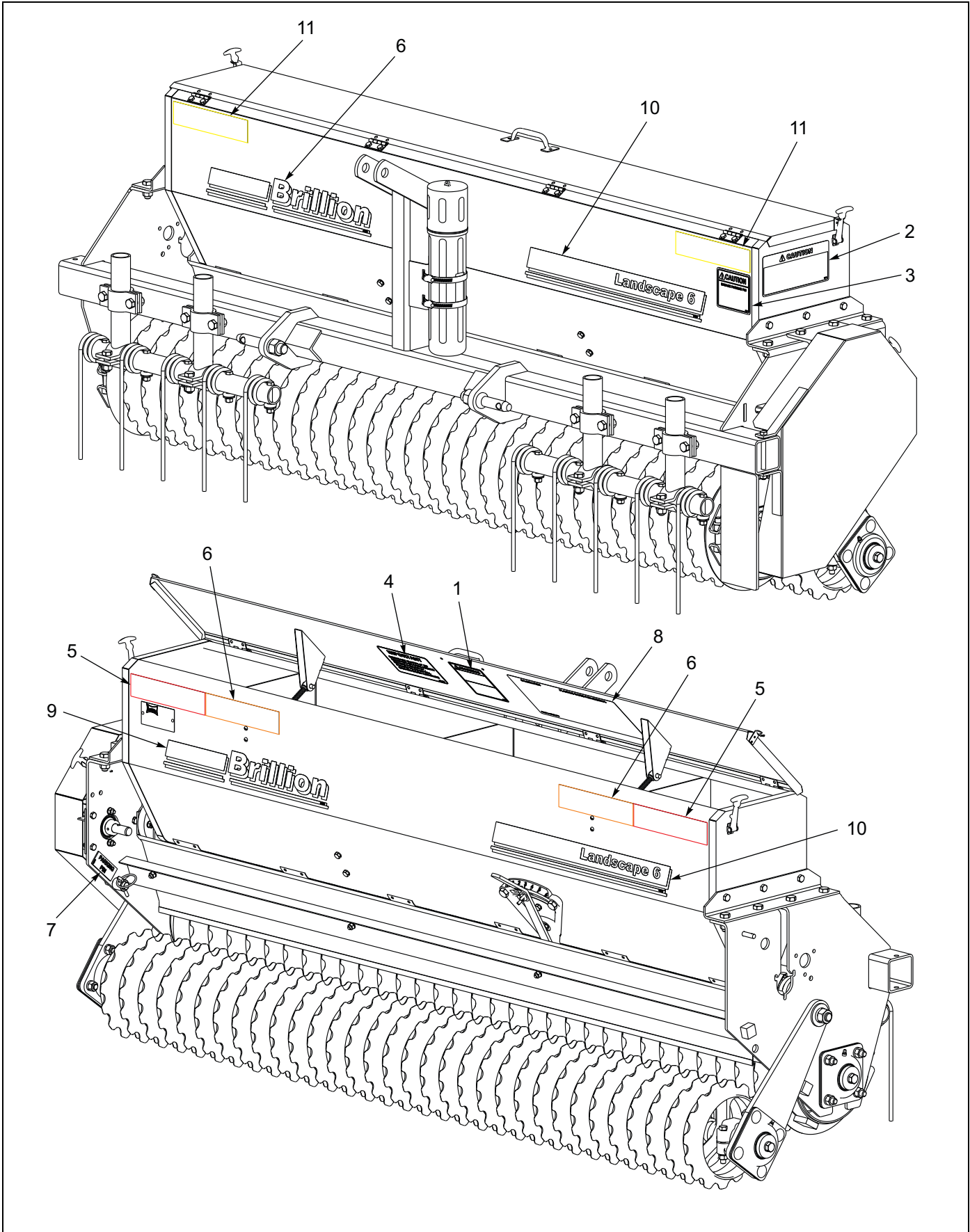

Figure 1-3: Decal Locations

Chapter 2

Operation

Landscape Seeder Operation

The Brillion Landscaper Seeder is fully assembled from the factory. This section refers to how to successfully operate your machine. Refer to the parts catalog for complete part breakdowns. Be sure to read and understand the Safety Procedures and Cautions starting on page 1-2.

"Left" and "Right" designation is determined by facing the direction the machine will travel during field operation, unless otherwise stated.

- If pre-assembled parts or fasteners are temporarily removed, remember where they go. It is best to keep parts separated.
- Check that all working parts move freely, bolts are tight and cotter pins are spread.
- Refer to the Torque Chart in Chapter 4 for proper bolt torque values.

Note the different torque requirement for bolts with lock nuts. Refer to Torque Chart in Chapter 4.



DANGER

Always be sure the front of the tractor has enough weight to maintain control when the machine is raised.



WARNING

When transporting on roadways, obey all applicable laws and regulations.

Do not transport at speeds over 20 mph under good conditions. Never travel at a speed which does not allow adequate control of steering or stopping.

Avoid sudden stops or turns because the weight of the machine may cause the operator to lose control of the tractor.

Make sure your slow moving vehicle sign is clean and visible.

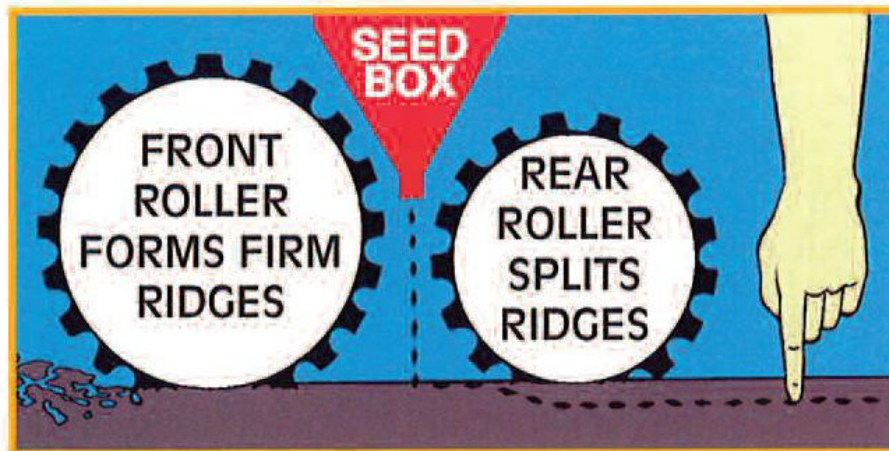

Front rollers crush lumps, press down small stones and form a firm seedbed. Precision seeding devices meter out the seed onto the well prepared seedbed. Rear rollers split the shallow ridges formed by the front rollers and gently firm the soil around the tiny seeds.

Figure 2-1: Landscape Grass Seeder Concept

OPERATION

Attaching to a Tractor

When hooking up seeders:

- Attach tractor.
- Remove klik pin, pull parking pin into outer position,
- Replace klik pin.

When unhooking seeder:

- Remove klik pin, push in parking pin,

- Replace klik pin.
- Disconnect tractor.

On LSS6, skid steer models, there is a parking pin located on each side of the frame. In addition, a quick attach frame attaches to the rear frame tube of the seeder by means of two pins and klik pins. See Figure 2-2.

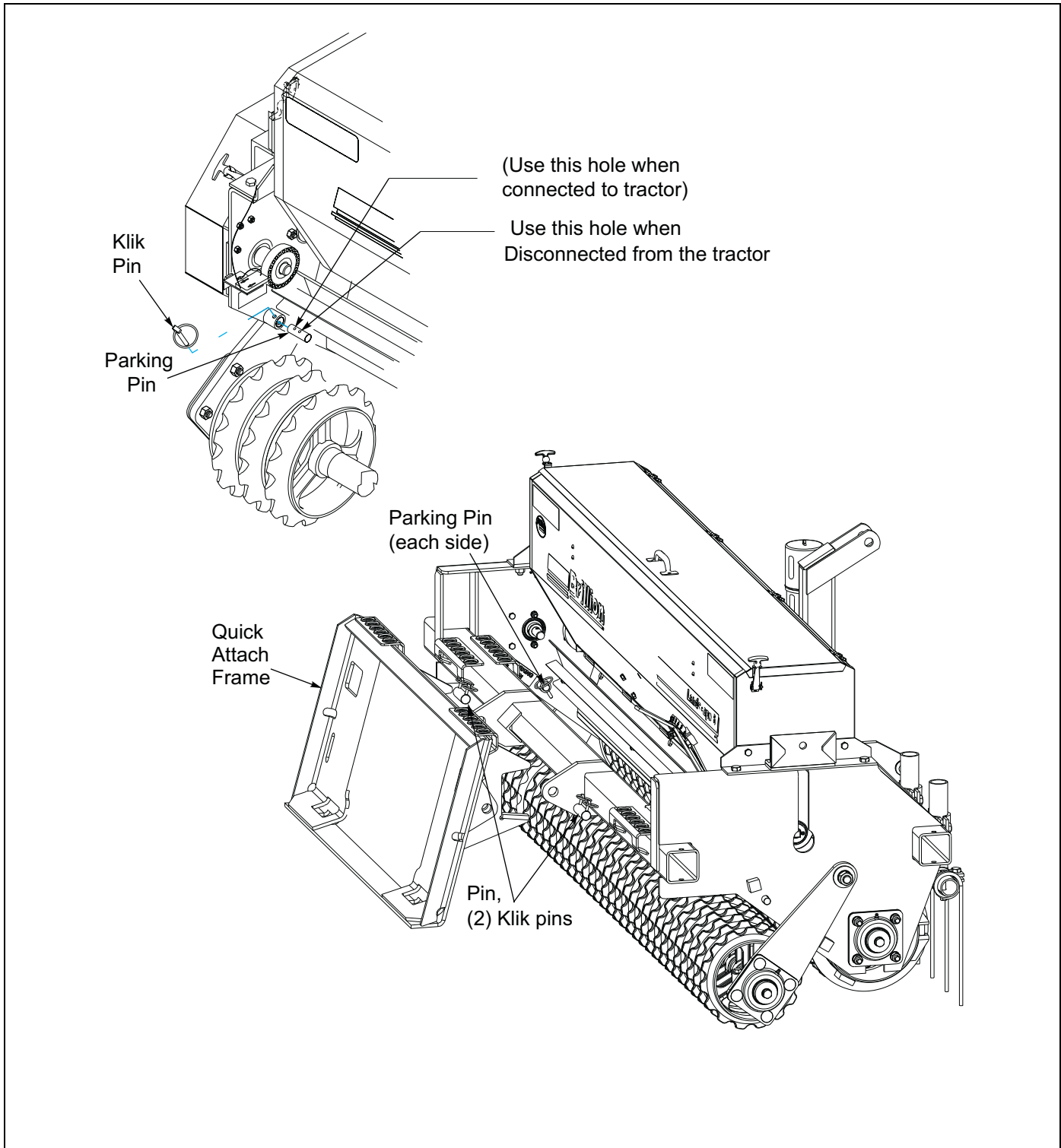

Figure 2-2: Attaching to a Tractor

Seed Rate Adjustment-Adjusting the Box Slide

When properly adjusted, with the control handle set at “6”. The holes in the slide should line up with the holes in the box, See Figure 2-3. To make an adjustment, loosen the control handle on the box, move the slide until the holes line up. When the handle is moved to “0” the holes in the box should be completely covered. See Figure 2-4.

If the holes are not covered, loosen the three bolts holding the seedmeter casting and shift it slightly so that the “0” mark is farther from the control handle. Retighten the bolts. Move control handle to “0”. Holes in the box should then be completely covered. See Figure 2-5.



Figure 2-3: Control Handle at “6”

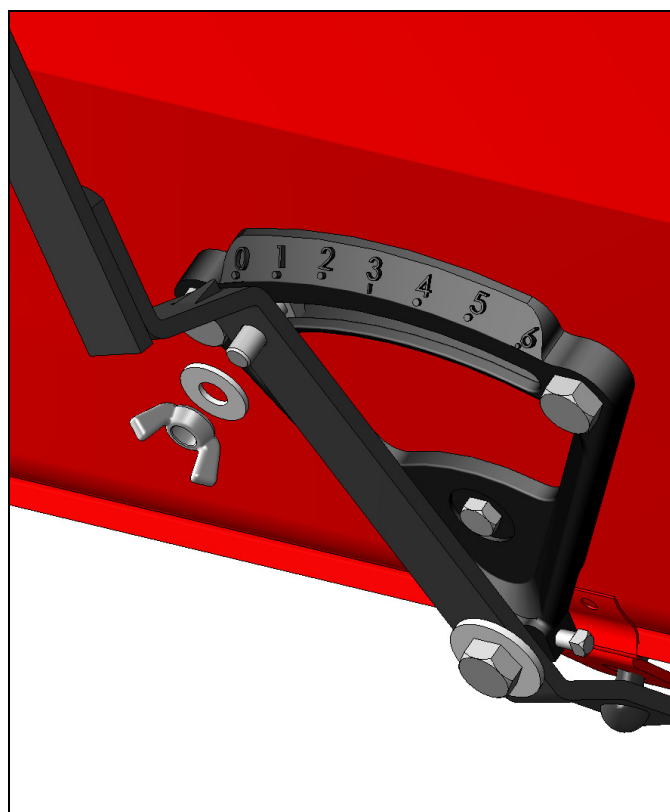

Figure 2-4: Control Handle at “0”

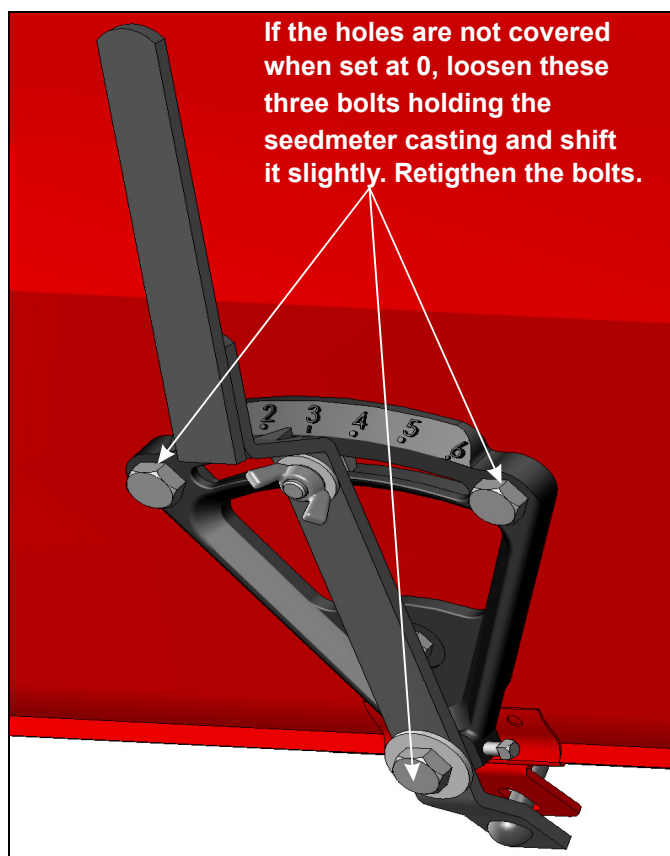

Figure 2-5: Seedmeter Casting Bolts

OPERATION

Calibration of the Seed Box

Seed box may be calibrated for unlisted seeds as follows:
See Figure 2-6.

1. Raise machine and lock in transport position.
2. Place a tarp under machine to collect seed.
3. Turn the idler shaft 232 revolutions counterclockwise.
4. Weigh seed and multiply by 10 (20 for 26-Tooth Driver) for approximate planting rate in lbs/acre.

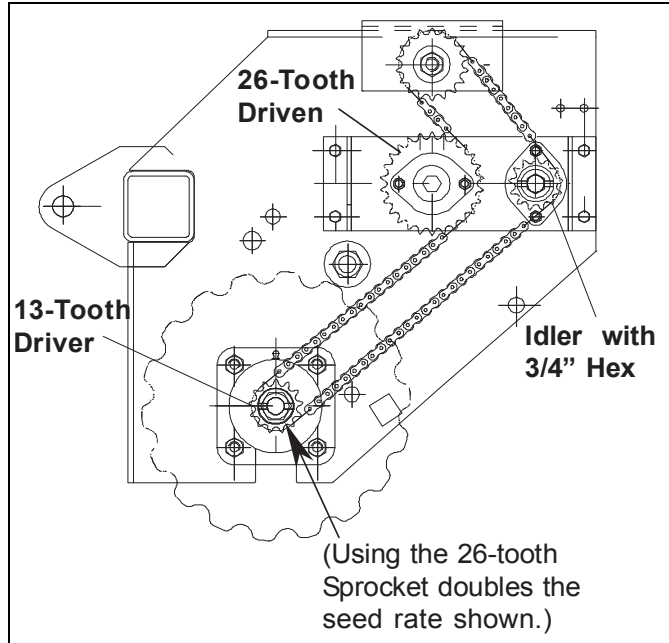

Figure 2-6: Seed Box Calibration

Planting Rates for Seed Box

1. See Figure 2-7. Double these rates for 26-Tooth Driver.
2. Rates are intended as a guide only. Variation in size and cleanliness will affect rates.

Check acreage & lbs. of seed used for best results.

INDICATOR SETTINGS	POUNDS PER ACRE						POUNDS PER 1000 SQ FT					
	1	2	3	4	5	6	1	2	3	4	5	6
SEEDER EQUIPPED WITH BRUSH AGITATORS												
Bent Grass, Highland	222	404	-	-	-	-	5.1	9.3	-	-	-	-
Bluegrass, Kentucky	58	187	298	391	-	-	1.3	4.3	6.8	9.0	-	-
Bluegrass, Merion	29	156	272	356	455	-	0.7	3.6	6.2	8.2	10.4	-
Fescue, Creeping Red	10.5	23	37	78	139	331	0.24	0.52	0.84	1.8	3.2	7.6
Oats*	-	20	81	131	209	258	-	0.5	1.9	3.0	4.8	5.9
Ryegrass, Annual	37	138	261	397	606	797	0.8	3.2	6.0	9.1	13.9	18.3
Ryegrass, Perennial	30	124	246	378	578	797	0.7	2.8	5.6	8.7	13.3	18.3
Wheat Grass, Tall	7	23	56	101	162	279	0.2	0.5	1.3	2.3	3.7	6.4
SEEDER EQUIPPED WITH BLADE AGITATORS												
Bent Grass, Highland	-	-	-	-	-	-	-	-	-	-	-	-
Bluegrass, Kentucky	52	227	505	836	1185	1638	1.2	5.2	11.6	19.2	27.2	37.6
Bluegrass, Merion	-	-	-	-	-	-	-	-	-	-	-	-
Fescue, Creeping Red	1.7	51	61	105	174	383	0.04	1.2	1.4	2.4	4	8.8
Oats*	17	70	174	296	418	470	0.4	1.6	4.0	6.8	9.6	10.8
Ryegrass, Annual	35	127	232	378	558	776	0.8	2.9	5.3	8.7	12.8	17.8
Ryegrass, Perennial	33	117	204	375	533	760	0.8	2.7	4.7	8.6	12.2	17.4
Wheat Grass, Tall	7	19	40	73	112	188	0.2	0.4	0.9	1.7	2.6	4.3

* Low germination may occur due to shallow seeding depth for this seed.

Figure 2-7: Seed Rate Chart 13 Tooth Driver

Doubling the Seed Rate

Seed rates can be doubled by using the 26-tooth sprocket and extra chain links included with the seeder. See Figure 2-8.

Procedure is as follows:

1. Loosen drive chain.

2. Open chain at connector.
 3. Remove 1/4" roll pin in 13-tooth sprocket and 3/4" nut on 26-tooth sprocket. See Figure 2-9.
 4. Exchange sprockets to new positions and replace roll pin and nut.
 5. Add extra chain links as provided with this seeder.
- Adjust chain tension as shown on page 4-3.*

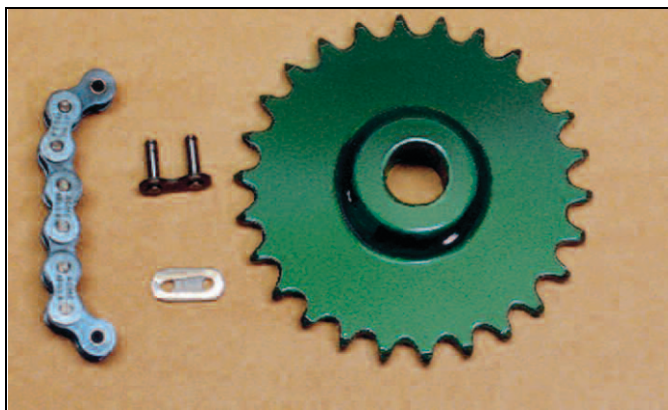

Figure 2-8: Speed Up Kit

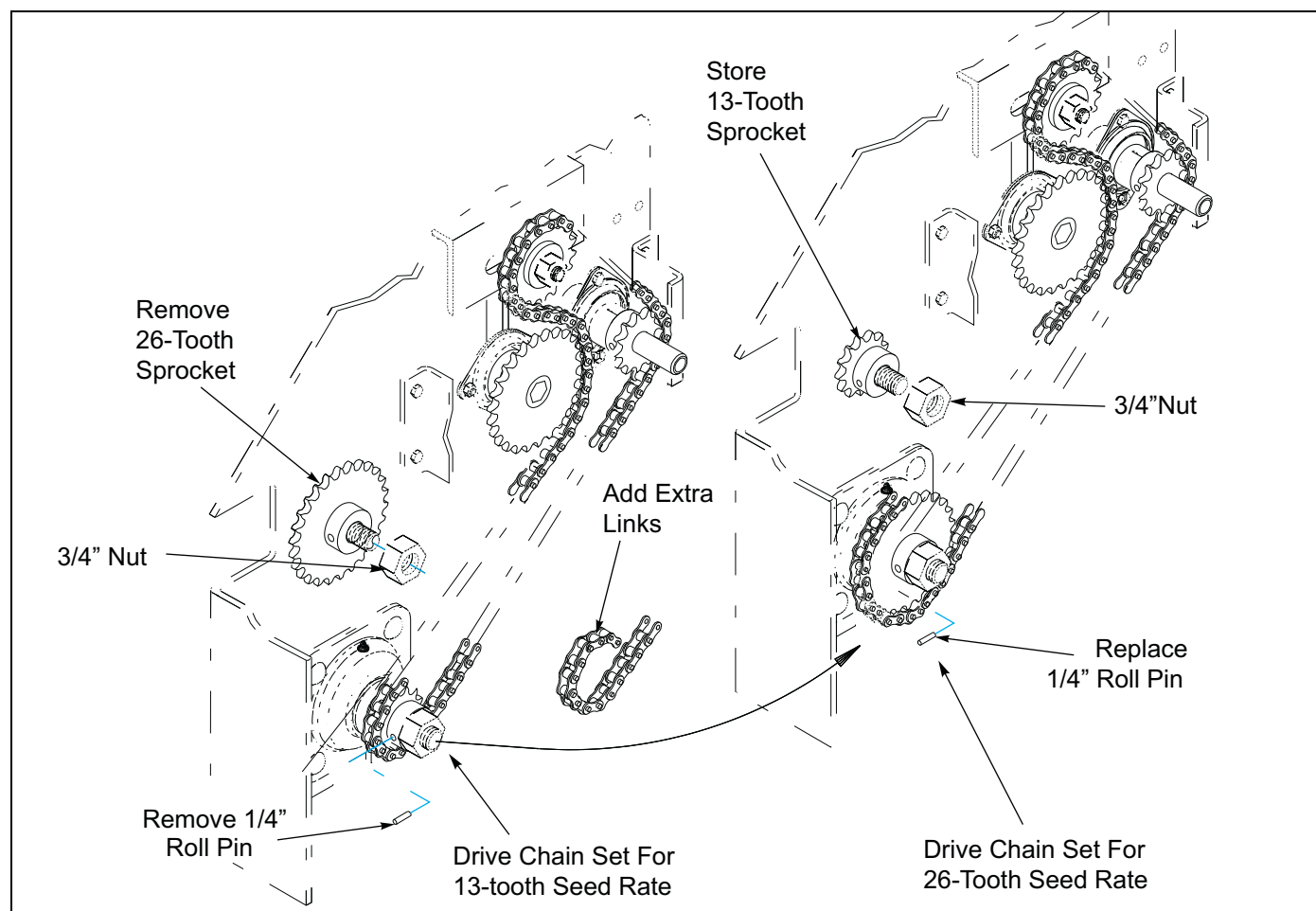

Figure 2-9: Doubling the Seed Rate

Acre Meter (Optional)

Settings for Loup Acre Meters After 05/15/2012

The battery operated acre counter operates in one of two modes. In sleep mode, the display is blank, and the counter is accumulating acres. Sleep mode will be entered if a button is not pressed for 20 seconds. In entry mode, the display is on, and the operator can enter values. To get into entry mode, press the ***/FUNC** button. If you continue to press the ***/FUNC** button, the acre counter will cycle through the functions that it can perform. The LEDs above the display indicate which function is selected.

The available functions are:

Field Acres, Total Acres, Pulses per 400 ft, Width, Password and Low Battery

Field Acres

Press the ***/FUNC** button until the **"FIELD"** LED is lit. The digits indicate the acres covered since the field acre counter was cleared.

To clear the field acre count, press the **UP** and **DOWN** buttons simultaneously for two seconds. If a password has been entered, you will not be able to clear the total acre count. Field acres will count in tenths of an acre up to 9999.9 acres.

Total Acres

Press the ***/FUNC** button until the **"FIELD"** and **"TOTAL"** LEDs are lit. The digits indicate the acres covered since the total acre counter was cleared.

To clear the total acre count, press and hold the **UP** and **DOWN** buttons for two seconds. If a password has been entered, you will not be able to clear the total acre count. Total acres will count from .1 to 99999 acres.

Pulses Per 400 Feet

Press the ***/FUNC** button until the **"PULSES"** LED is lit. The number in the display indicates how many pulses are generated for every 400 feet driven. There are two methods to enter the pulses per 400 feet:

If you know the number, select it using the **UP** and **DOWN** buttons. When you press the ***/FUNC** button, the Acre Counter will accept the number in the display as the new pulses per 400 feet. See Table 2-1.

If you do not know the pulses per mile, press and hold the **UP** and **DOWN** buttons until the "0000" appears in the display. The **"PULSES"** LED will blink. The acre counter is now counting shaft rotations. Enter the cab and drive 400 feet. Press the ***/FUNC** button to wake up the acre counter. The **"PULSES"** LED will again blink. The number displayed is the pulses per 400 feet. Press the ***/FUNC** button to accept the setting. The **"PULSES"** LED will stop blinking and remain on.

If a password is set, you will not be able to adjust the pulses per mile.

Width

Press the ***/FUNC** button until the **"WIDTH"** LED is lit. The number displayed is the length of your implement in feet.

To adjust the width, press the **UP** and **DOWN** buttons. If a password has been entered, you will not be able to adjust the width.

The length can be adjusted from .1 to 99.9 feet, in tenths of a foot.

Password

The password function allows you to protect the total acre count, pulses per 400 feet, and width settings with a password. This stops anyone from accidentally changing those settings. When the acre counter is shipped, the password is disabled. You can modify the pulses per 400 feet and implement width at any time.

Press the ***/FUNC** button until the **"PASS"** LED is lit. The digits will display the word **"Ent"** or **"dis"**.

If the display shows **"dis"**: The password is disabled. The total acre count, pulses/400 ft, width, and password settings can be adjusted using the **UP** and **DOWN** buttons. The password can also be changed using the **UP** and **DOWN** buttons.

If the display shows **"Ent"**: You must enter your password using the **UP** and **DOWN** buttons. When your password is displayed, press the ***/FUNC** button to test the password. If the password is correct, you will be able to change the acre counter settings. The password will be viewable until the acre counter powers down. When the acre counter is powered up again, you will have to re-enter the password to change settings.

If the password is not correct, you will not be able to change the acre counter settings. When the **"PASS"** function is selected again, **"Ent"** will appear in the display.

Changing The Password

Select a new password using the **UP** and **DOWN** buttons. Press the ***/FUNC** button until the word “**SET**” appears in the display. Release the ***/FUNC** button. The number in the display is your new pass code. Make sure you record this number. Press and hold the ***/FUNC** button until the word “**dis**” appears in the display.

If the password is forgotten, it can be disabled by removing the batteries. The password is intended for rental units. It is recommended that a seal be affixed to the rear plate of the acre counter to determine if the settings have been tampered with.

Quick-start Settings for Loup Acre Meters Prior to 05/15/2012

- When the meter is set to “count” mode in pulses screen, meter will register only magnetic wheel revolutions.
- The meter must be in sleep mode (blank screen) to calculate acres or to count pulses.
- The count screen must have a value other than zero (0000) to scroll to other modes or screens.
- To reset the FIELD ACRES screen to zero (0000), press the up and down buttons simultaneously.

To Program Meter

1. Press the function button to scroll to pulses screen.
2. Enter the number of pulses using the up or down buttons for the model listed in the chart. See Table 2-2.
3. Press the function button to set the pulses. (If screen goes blank before you press the function button, repeat steps 1 and 2).
4. Press the function button to scroll to the width screen.
5. Enter the width of seeder using the up or down buttons for the model listed in the chart. See Table 2-2.
6. Press the function button to set the width. (If screen goes blank before you press the function button, repeat steps 4 and 5).
7. Press the function to scroll through the screens to check that the correct pulses and width have been entered.

To Enter Password

1. Press the function button to scroll to password screen.
2. Pick a numeric password and enter it by using the up or down buttons, until your password is displayed.

3. Press the function button to set password; screen will show “(set)”. Record number - it is required if you decide to disable password.
4. Let screen go blank - password is now entered.
5. Press the function button to scroll to the password screen it will show (ent). If the screen does not show (ent), repeat steps 2, 3 and 4.

To Disable Password

1. Press the function button to scroll to the password screen it will show (ent).
2. Use up or down button to enter password (number).
3. Press the function button to scroll around to pass screen again. Number entered in step 2 will appear.
4. Press up or down button to enter 0.
5. Press the function button; (dis) will appear. Password is now disabled.

Battery Replacement

The battery operated acre counter uses 3 AA batteries. The batteries should last between 5 and 10 years. The acre counter will last much longer than that. Eventually, you will have to replace the batteries. The “**BATT**” LED will light when the batteries require replacement. Remove the acre counter from the implement and undo the 4 screws on the back of the case. This will separate the housing from the rear plate. Replace the batteries with 3 high quality AA alkaline batteries.

This unit is dust and splash resistant, under no circumstances should this unit be submerged in any conductive, corrosive, or flammable liquid.

OPERATION

Table 2-1: Acre Meter Settings (After 05/15/2012)

MODEL				Pulses	Width
SSP T604				22	5
SSP4		SS4		44	4
SSP5				44	5
SSP6		SS6		44	6
SSP8		SS8		58	8
SSP10		SS10		58	10
SSP12		SS12		58	12
SSP108		SS108		58	8
SSP110		SS110		58	10
SSP112		SS112		58	12
SSP208	SSP2081	SS208	SS2081	58	8
SSP210	SSP2101	SS210	SS2101	58	10
SSP212	SSP2121	SS212	SS2121	58	12
SSP308		SS308		29	8
SSP310		SS310		29	10
SSP312		SS312		29	12
SLP8		SL8		314	8
SLP10		SL10		314	10
SLP12		SL12		314	12
SLP204	SLP2041			128	4
SLP206	SLP2061			128	6
SLP304	SLP3041			64	4
SLP306	SLP3061			64	6
LSP5				128	5
LSP6				128	6
LSS6				128	6
SLP208	SLP2081	SL208	SL2081	116	8
SLP210	SLP2101	SL210	SL2101	116	10
SLP212	SLP2121	SL212	SL2121	116	12
SLP308	SLP3081	SL308	SL3081	58	8
SLP310	SLP3101	SL310	SL3101	58	10
SLP312	SLP3121	SL312	SL3121	58	12
BOS4F1	BOS4S1	BOS6F1	BOS6S1	45	4
BOSB4F1	BOSB4S1	BOSB6F1	BOSB6S1	45	6
BPS6	BPSB6			51	6
GLP643		SSLP643		69	5

Table 2-2: Acre Meter Settings (Prior to 05/15/2012)

MODEL				Pulses	Width
SSP T604				293	5
SSP4		SS4		578	4
SSP5				578	5
SSP6		SS6		578	6
SSP8		SS8		764	8
SSP10		SS10		764	10
SSP12		SS12		764	12
SSP108		SS108		760	8
SSP110		SS110		760	10
SSP112		SS112		760	12
SSP208	SSP2081	SS208	SS2081	764	8
SSP210	SSP2101	SS210	SS2101	764	10
SSP212	SSP2121	SS212	SS2121	764	12
SSP308		SS308		382	8
SSP310		SS310		382	10
SSP312		SS312		382	12
SLP8		SL8		4147	8
SLP10		SL10		4147	10
SLP12		SL12		4147	12
SLP204	SLP2041			1690	4
SLP206	SLP2061			1690	6
SLP304	SLP3041			845	4
SLP306	SLP3061			845	6
LSP5				1690	5
LSP6				1690	6
LSS6				1690	6
SLP208	SLP2081	SL208	SL2081	1528	8
SLP210	SLP2101	SL210	SL2101	1528	10
SLP212	SLP2121	SL212	SL2121	1528	12
SLP308	SLP3081	SL308	SL3081	764	8
SLP310	SLP3101	SL310	SL3101	764	10
SLP312	SLP3121	SL312	SL3121	764	12
BOS4F1	BOS4S1	BOS6F1	BOS6S1	600	4
BOSB4F1	BOSB4S1	BOSB6F1	BOSB6S1	600	6
BPS6	BPSB6			679	6
GLP643		SSLP643		917	5

OPERATION

Adjustment of Wheel Track Remover

The depth of the wheel track removers can be adjusted as shown. See Figure 2-10. Loosen the 1/2" capscrews, lockwashers and nuts that secure the clamps to the coil tine supports. Adjust the supports up or down to the desired depth and then retighten the nuts on the screws. Do this for each pipe and tine assembly.

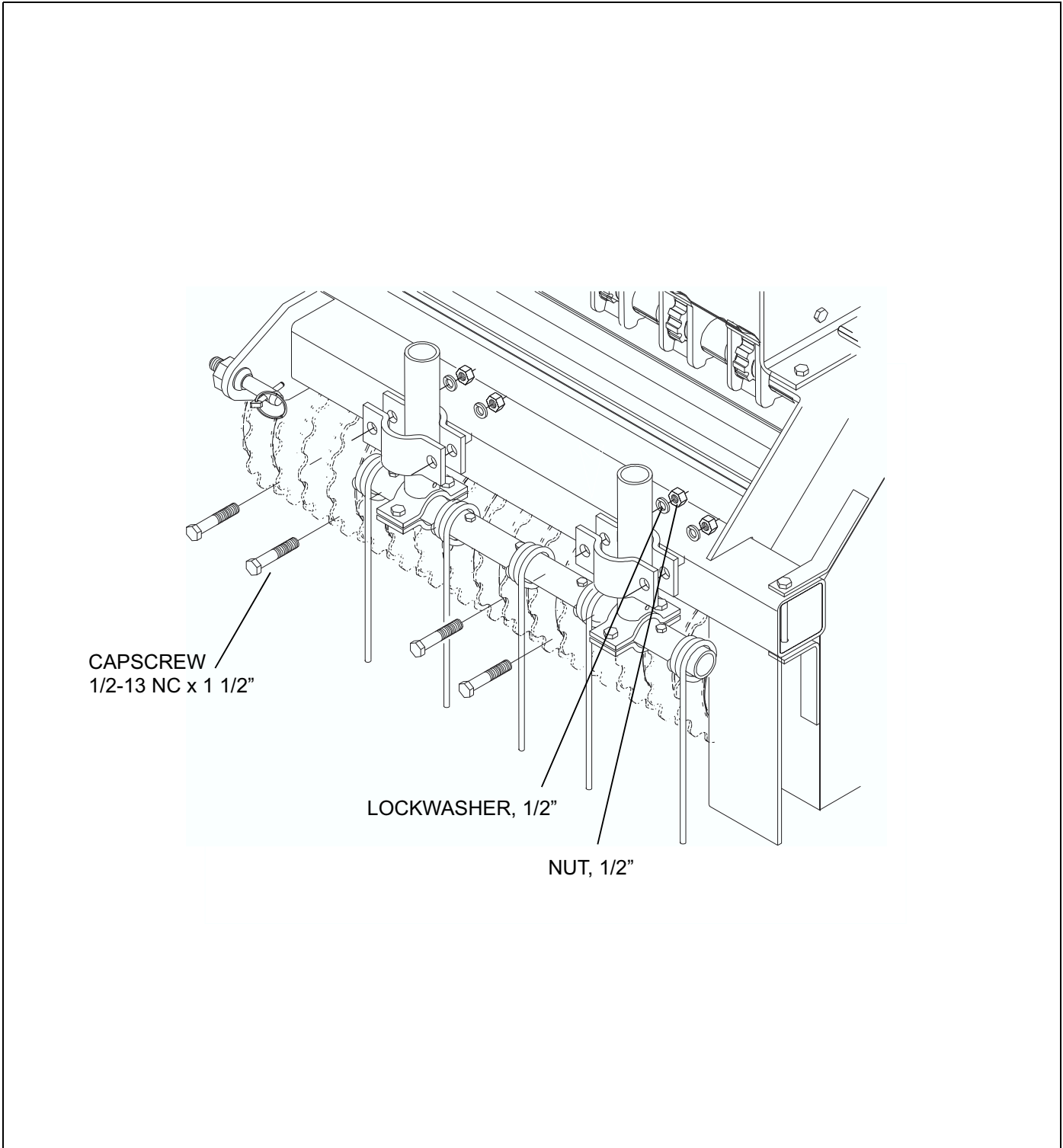

Figure 2-10: Wheel Track Remover

Assembly Of Optional Equipment

Agitator Blades (Optional Cage or Brushes)

Agitator blades are supplied as standard on your seedbox. They should operate leaving a slight clearance with the bottom of the seed box.

Agitator brushes (optional) in the seed box sweep the bottom of the box to control the flow of seed. However, if they exert too much pressure on the bottom of the box, chain breakage and excessive brush wear can possibly result. To overcome excessive pressure of the brushes on the bottom of the box, the bolts holding the triangular cast iron bearings can be loosened and the bearings raised to reduce excessive drag. The holes in the bearing are slightly larger than the bolts holding them, thus making an adjustment possible.

Cage agitator (optional) operates similar to blades.

Changing Agitator Kits

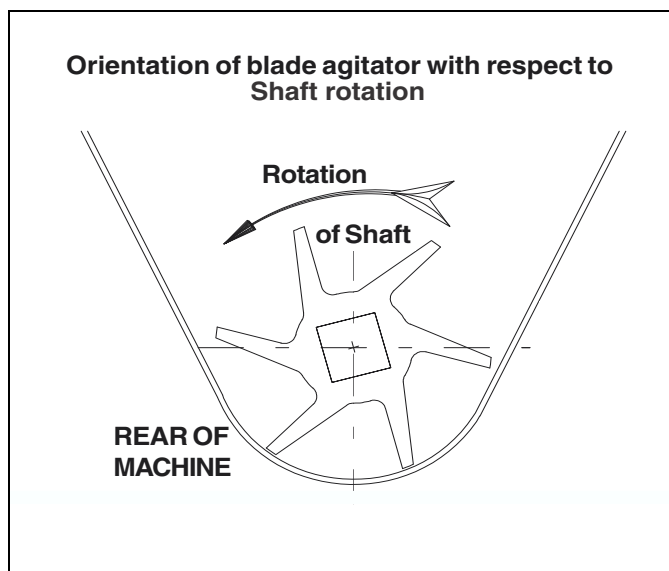

Figure 3-1: Shaft Rotation

IMPORTANT

Before proceeding with any agitator installation, be sure to note the direction of shaft rotation on your seeder. See Figure 3-1.

1. Remove two bolts which hold end bearing on the right end of the right seed box. See Figure 3-2.
2. Slide the shaft out of the right end.
3. Agitators should be installed with careful attention to the direction of shaft rotation as the seed rate will be reduced if they run "backwards". In addition, brush agitators will be damaged if not run in the proper direction.



CAUTION

The brushes will be destroyed if installed backwards.

4. With the agitators properly seated in the boxes, replace the drive shafts. Replace washers as needed for fit.
5. Check to be sure agitators rotate freely. Some seeders may have bolts extending into the seed box causing inference. These bolts will need to be shortened.
6. Apply Important Decal 5D505 to the front seedbox visible by the tractor driver.

IMPORTANT

DISENGAGE CLUTCH (IF SO EQUIPPED) OR RAISE SEEDER BEFORE BACKING UP. FAILURE TO DO SO WILL DAMAGE BRUSH AGITATORS.

5D505

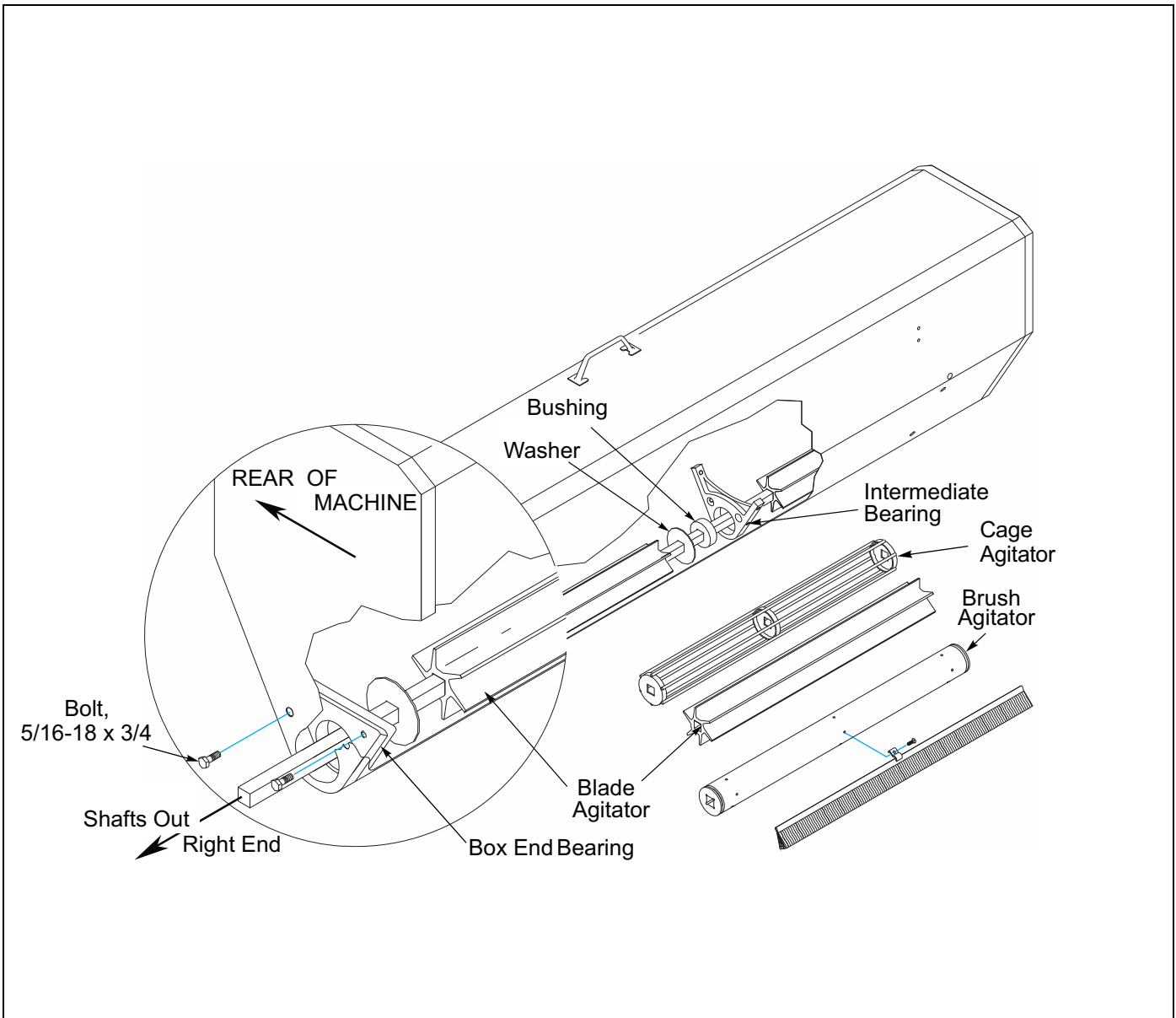

Figure 3-2: Agitator Blades

Lift Sling Kit (Optional)



WARNING

Stay clear of machine when using the lift sling to lift or move it. Do not work under machine using only the sling to support it. Keep observers away.

1. Attach a mounting bracket to the left side of machine and a mounting bracket and strap to the right side of machine at the center holes of the right and left end plates. Use 1/2" x 1 3/4" capscrews found in the kit box assembly and the nuts already used on the endplates. See Figure 3-3.
2. Attach lift sling to mounting brackets with 5/8" x 1 1/2" capscrews and stover nuts provided in kit.
3. Slide stabilizer into frame tube and secure with clevis pin and hairpin cotter.

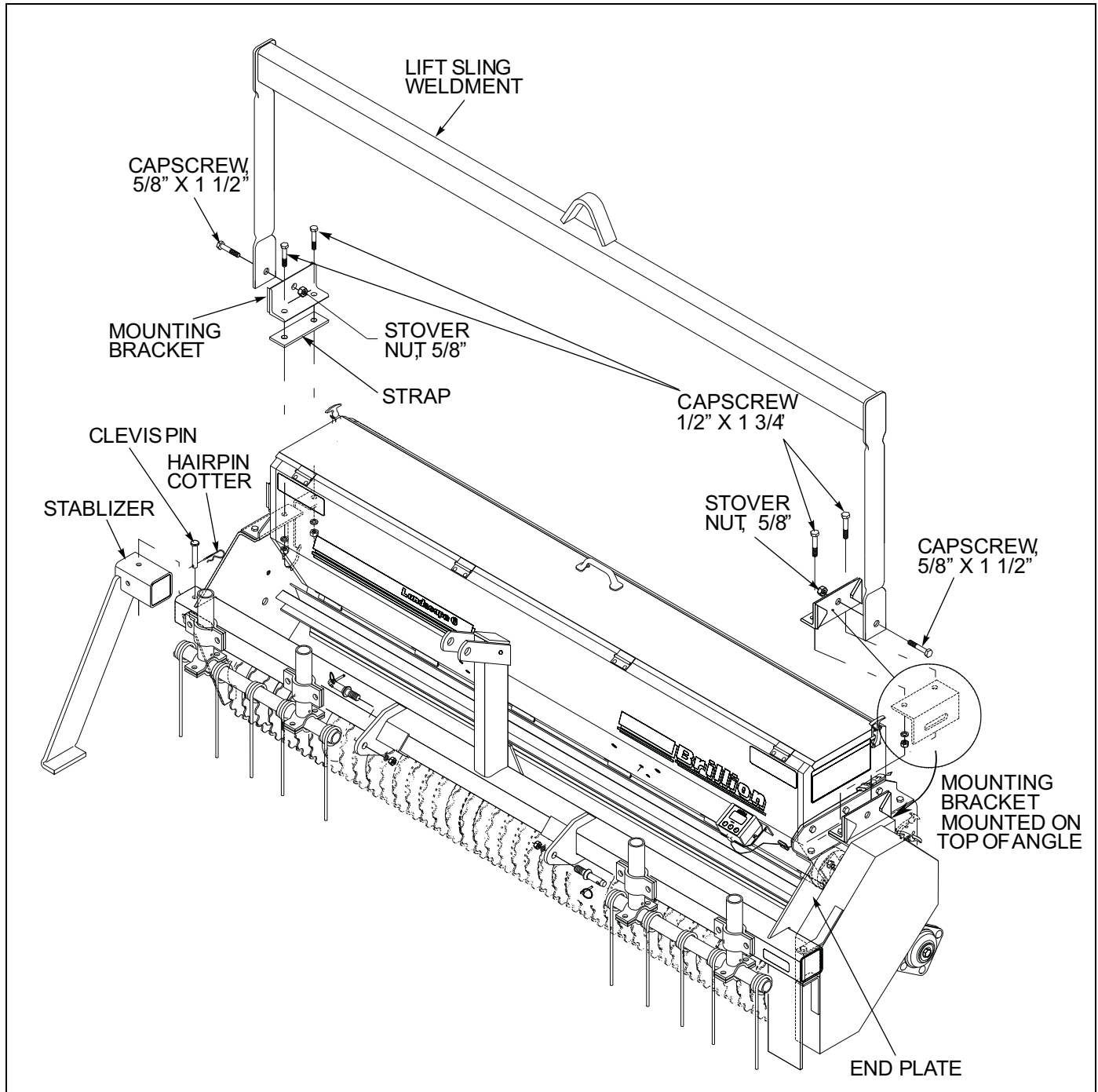

Figure 3-3: Lift Sling Kit

Acre Meter Kit 6K036 Installation

The Acre Meter Kit consists of four main parts; Acre Meter Assembly, Pick-up Switch Bracket, Pick-up Switch, and Magnet Wheel.

1. Drill $13/32$ " holes into seedbox at location shown. See Figure 3-4.
2. Next, use $3/8-16$ NC x 1" capscrews, lockwashers, and nuts to attach the bracket which holds the acre meter, as shown, onto the left front of the seedbox.

3. Mount the acre meter onto this bracket with #10-24 x 1" machine screws, lockwashers and nuts.
4. Run the wire from the bottom of the meter down the side of the seed box and along its left side. Use mounting bases to hold the wire in place. Run it across the plate which attaches the seedbox to endplate. Here, it will plug into the mating cable from the pick-up.



WARNING

Do not pressure clean with air or water.

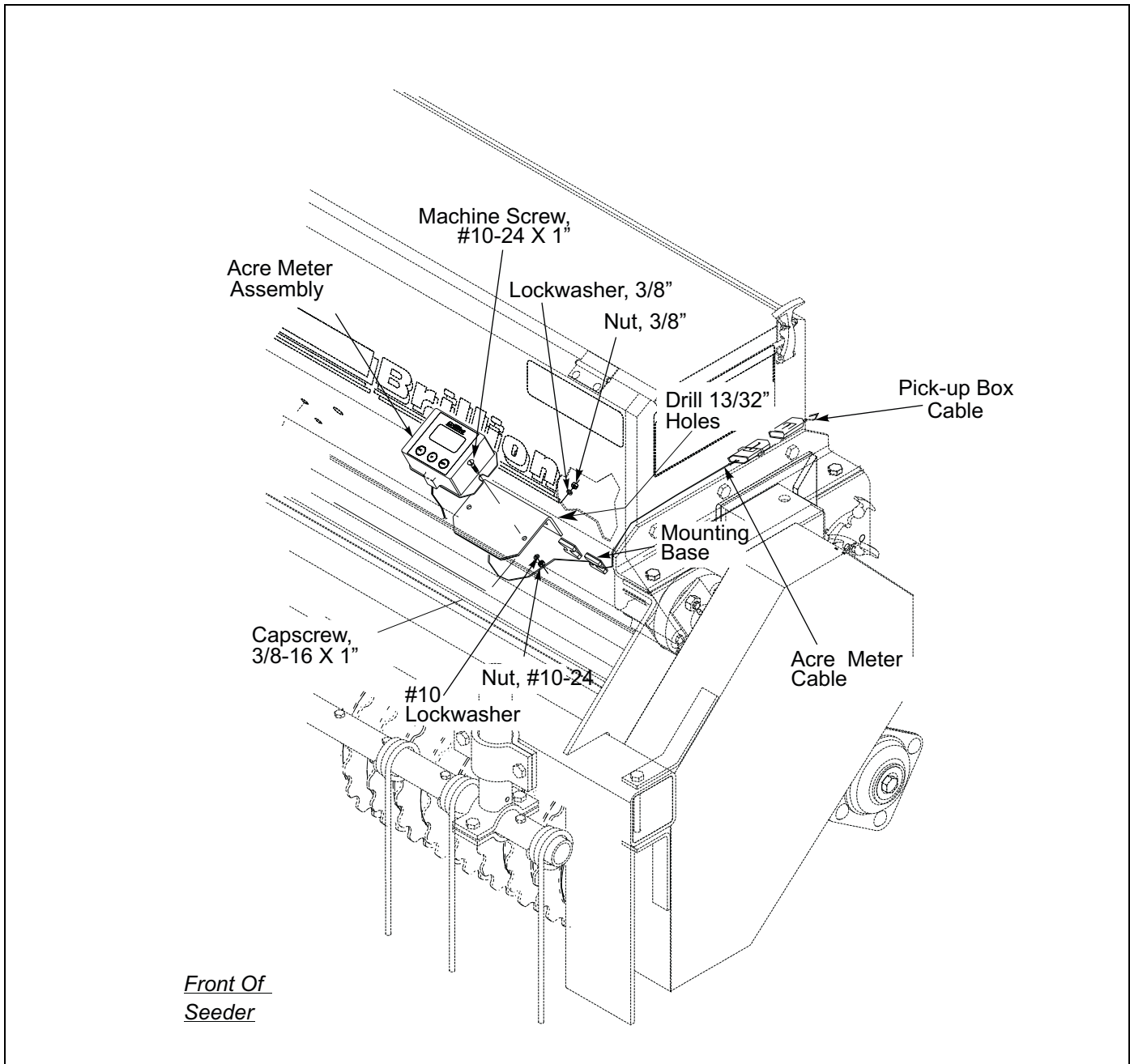

Figure 3-4: Acre Meter Installation (1 of 2)

Acre Meter Kit 6K036 Installation (continued)

5. At the rear of the seeder, mount the L-shaped bracket to the end plate with a 5/8-11 x 1 1/2" capscrew and locknut as shown. The small shoulder on the bracket should butt up against the end plate of the seeder frame.
6. On top of this bracket mount the pickup with two #8-32 x 1 1/4" machine screws, flat washers, lockwashers, and nuts.

Extend its longer wire up toward the side of the seedbox to meet the wire from the acre meter. Attach its shorter wire to the ground on the bracket. (Remove paint under the terminal to ensure a good electrical connection.)

7. Press or slide Magnet Wheel onto Drive Shaft until it is vertically centered with the Pick-up Switch.
8. Adjust the Pick-up Switch so the centerline of Magnet Wheel and Pick-up Switch are horizontally and vertically aligned with a maximum 1/8" gap between them. Firmly tighten Switch to bracket and tighten set screw (if present) in Wheel.

Alignment of Pick-up Switch and Magnet Wheel is critical. Improper alignment will cause the Acre Meter to record acres erratically or not at all.

9. Route Pick-up Switch Cable up to the Acre Meter Cable and connect mating plugs.
10. Securely fasten cable to frame using the adhesive Cable Tie Mounting Base and Cable Ties to prevent cable from becoming entangled or rubbing on moving parts.

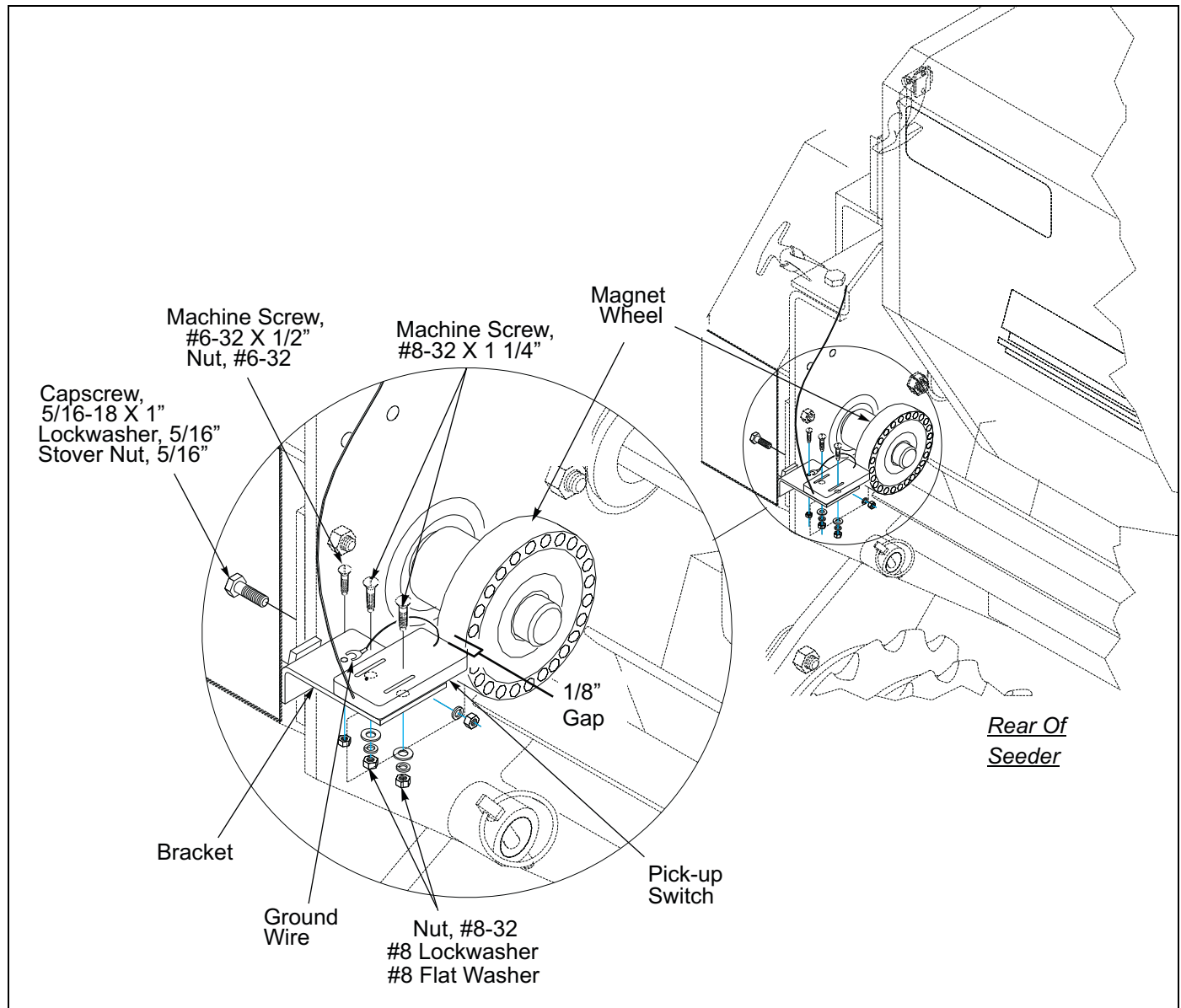

Figure 3-5: Acre Meter Installation (2 of 2)

Page Intentionally Blank

Maintenance

General Torque Specifications

This chart provides tightening torques for general purpose applications when special torques are not specified on process or drawing. Assembly torques apply to plated nuts and capscrews assembled without supplemental lubrication (as received condition). They do not apply if special graphite moly-disulfide or other extreme pressure lubricants are used. When fasteners are dry (solvent cleaned) add 33% to as received condition torque. Bolt head identification marks indicate grade and may vary from manufacturer to manufacturer. Thick nuts must be used on grade 8 capscrews. Use value in [] if using prevailing torque nuts

TORQUE SPECIFIED IN FOOT POUNDS

UNC SIZE	SAE Grade 2	SAE Grade 5	SAE Grade 8	UNF SIZE	SAE Grade 2	SAE Grade 5	SAE Grade 8
1/4-20	4 [5]	6 [7]	9 [11]	1/4-28	5 [6]	7 [9]	10 [12]
5/16-18	8 [10]	13 [13]	18 [22]	5/16-24	9 [11]	14 [17]	20 [25]
3/8-16	15 [19]	23 [29]	35 [42]	3/8-24	17 [21]	25 [31]	35 [44]
7/16-14	24 [30]	35 [43]	55 [62]	7/16-20	27 [34]	40 [50]	60 [75]
1/2-13	35 [43]	55 [62]	80 [100]	1/2-20	40 [50]	65 [81]	90 [112]
9/16-12	55 [62]	80 [100]	110 [137]	9/16-18	60 [75]	90 [112]	130 [162]
5/8-11	75 [94]	110 [137]	170 [212]	5/8-18	85 [106]	130 [162]	180 [225]
3/4-10	130 [162]	200 [250]	280 [350]	3/4-16	150 [188]	220 [275]	320 [400]
7/8-9	125 [156]	320 [400]	460 [575]	7/8-14	140 [175]	360 [450]	500 [625]
1-8	190 [237]	408 [506]	680 [850]	1-14	210 [263]	540 [675]	760 [950]
1-1/8-7	270 [337]	600 [750]	960 [1200]	1-1/8-12	300 [375]	660 [825]	1080 [1350]
1-1/4-7	380 [475]	840 [1050]	1426 [1782]	1-1/4-12	420 [525]	920 [1150]	1500 [1875]
1-3/8-6	490 [612]	1010 [1375]	1780 [2225]	1-3/8-12	560 [700]	1260 [1575]	2010 [2512]
1-1/2-6	650 [812]	1460 [1825]	2360 [2950]	1-1/2-12	730 [912]	1640 [2050]	2660 [3325]
1-3/4-5	736 [920]	1651 [2063]	2678 [3347]	1-3/4-12	920 [1150]	2063 [2579]	3347 [4183]

METRIC:

Coarse thread metric class 10.9 fasteners and class 10.0 nuts and through hardened flat washers, phosphate coated, Rockwell "C" 38-45. Use value in [] if using prevailing torque nuts

Nominal thread diameter (mm)	Newton Meters (Standard Torque)	Foot Pounds (Standard Torque)	Nominal Thread Diameter (mm)	Newton Meters (Standard Torque)	Foot Pounds (Standard Torque)
6	10 [14]	7 [10]	20	385 [450]	290 [335]
7	16 [22]	12 [16]	24	670 [775]	500 [625]
8	23 [32]	17 [24]	27	980 [1105]	730 [825]
10	46 [60]	34 [47]	30	1330 [1470]	990 [1090]
12	80 [125]	60 [75]	33	1790 [1950]	1340 [1450]
14	125 [155]	90 [115]	36	2325 [2515]	1730 [1870]
16	200 [240]	150 [180]	39	3010 [3210]	2240 [2380]
18	275 [330]	205 [245]			

Fasteners

Before operating your Brillion machine, check all hardware for tightness. Use the Tightening Torque Table as a guide.

NOTE

After a few hours of use, check entire machine and tighten any loose nuts or bolts. Daily or periodic checks should be made thereafter.

- Values are given in foot-pounds.
- Use GRADE B lock nuts with GRADE 2 and GRADE 5 bolts only.
- Use GRADE C lock nuts with GRADE 8 bolts only.

Acre Meter

The battery operated acre counter uses 3 AA batteries. The batteries should last between 5 and 10 years. The acre counter will last much longer than that. Eventually, you will have to replace the batteries. The acre counter will display “LObAt” when the batteries require replacement. Remove the acre counter from the implement and undo the 4 screws on the back of the case. This will separate the housing from the rear plate. Replace the batteries with 3 high quality AA alkaline batteries.

Lubrication



WARNING

Do Not Lubricate Machine While Machine Is In Motion. If Any Guards Are Removed For Lubricating, They Must Be Replaced Before Operating.

- Grease all fittings every 20 hours of operation. Each of the four flange bearings supporting the rollers has a grease fitting. See Figure 4-1.
- Greaseable components are the same on each side, right side shown.
- Lubricate Roller Chains periodically with quality chain oil.

For best penetration, lubricate chain immediately after use while chain is still warm.

NOTE

It is good machine maintenance practice to check all bolts for tightness during regular lubrications. Tighten any fasteners that may have loosened during operation.

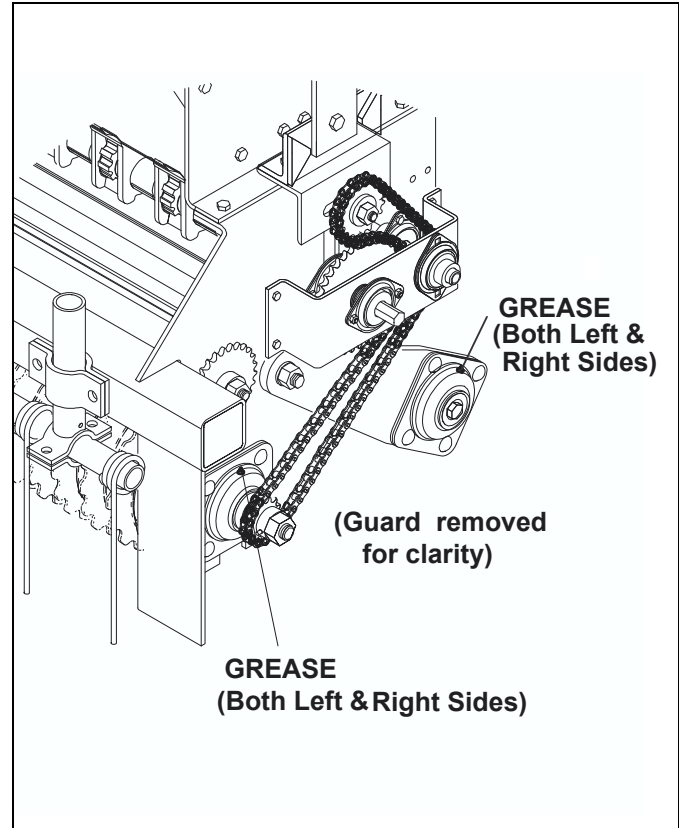

Figure 4-1 Lubrication Fittings

Chain Tension

Adjust the chain between the front roller and transmission to have approximately 1/4" to 3/8" of slack.

To adjust the chain:

1. Loosen the 5/8" idler axle bolt.
2. Lay a straight edge along the edges of the idler sprocket and the upper 13-tooth sprocket.
3. Use the bolt to obtain about 1/4" - 3/8" of sag in the chain. See Figure 4-2.
4. Re-tighten idler bolt.

Be careful not to over tighten this chain.

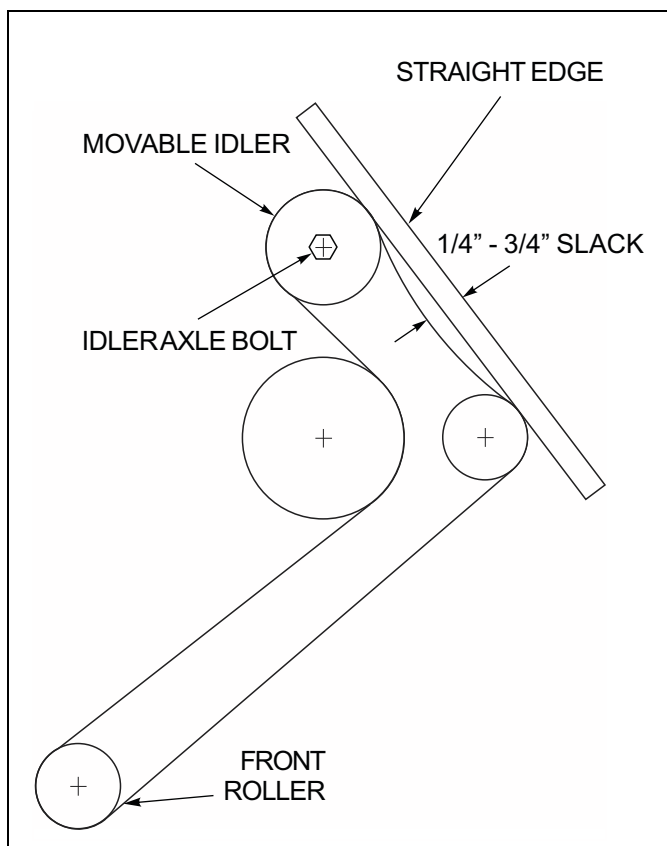

Figure 4-2 Chain Tension

Roller Wheels

Occasionally it is necessary to loosen clamp bands and tighten roller wheel assemblies. As nearly as possible, peaks on rear wheels should line up with valleys on front wheels. This requires adjusting both end clamps on the rear axle drum. See Figure 4-3.

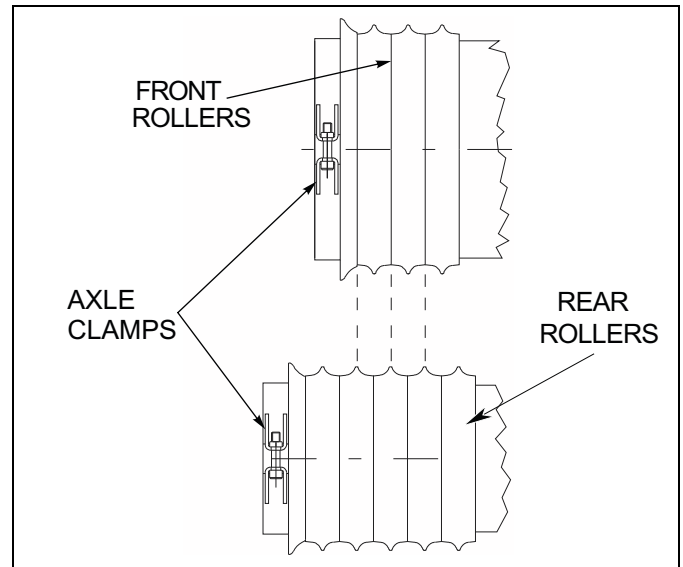

Figure 4-3: Roller Wheels

Maintenance Chart

(Subject to change without notice)

	Initial Run - In	20 Hours	Annually	Storage
Fasteners	X		X	
Lubricate Roller Chains	X	X		X
Adjust Roller Chain Tension	X	X	X	
**Clean Machine				X
Grease After Cleaning				X
Touch-Up Paint				X

** Avoid spraying high pressure water directly at bearing seals and electrical components.

Specifications

Brilliant Landscape Seeder Specifications Landscape Models

	LSP-5	LSP-6	LSS-6
Approximate Weight	924 lbs. (416 kg)	1,006 lbs. (453 kg)	1,242 lbs. (559 kg)
Working Width	5 ft. 0 in. (1.25 m)	6 ft. 0 in. (1.8 m)	6 ft. 0 in. (1.8 m)
Transport Width	6 ft. 0 in. (1.8 m)	7 ft. 0 in. (2.1 m)	7 ft. 0 in. (2.1 m)
Transport Height	Dependent Upon Tractor	Dependent Upon Tractor	Dependent Upon Tractor
Overall Height	3 ft. 7 in. (1.08 m)	3 ft. 7 in. (1.08 m)	3 ft. 7 in. (1.08 m)
Overall Length	2 ft. 6 in. (0.8 m)	2 ft. 6 in. (0.8 m)	2 ft. 6 in. (0.8 m)
Seed Box	All Steel Construction with Cover	All Steel Construction with Cover	All Steel Construction with Cover
Seed Box Capacity	3.75 bu	4.5 bu.	4.5 bu.
Seed Meters	Blade Agitator	Blade Agitator	Blade Agitator
Seed Meter Drive	Ground Driven	Ground Driven	Ground Driven
Seed Opening Spacing	3 in. (76.2 mm)	3 in. (76.2 mm)	3 in. (76.2 mm)
Seed Delivery	Broadcast with Wind Deflector Tray	Broadcast with Wind Deflector Tray	Broadcast with Wind Deflector Tray
Pulverizer Roller Front	11.5 in. (292 mm) Gray Cast Iron	11.5 in. (292 mm) Gray Cast Iron	11.5 in. (292 mm) Gray Cast Iron
Pulverizer Roller Rear	9.5 in. (241 mm) Gray Cast Iron	9.5 in. (241 mm) Gray Cast Iron	9.5 in. (241 mm) Gray Cast Iron
Pulverizer Axle Bearings	Greaseable	Greaseable	Greaseable
Pulverizer Axle Size Front	8.625 in. (219 mm)	8.625 in. (219 mm)	8.625 in. (219 mm)
Pulverizer Axle Size Rear	1.75 in. (45 mm)	1.75 in. (45 mm)	1.75 in. (45 mm)
Coil Tine Wheel Track Remover	Standard	Standard	Standard
Hitch	Cat. I-II Quick Hitch Compatible	Cat. I-II Quick Hitch Compatible	Cat. I Three-Point/Skid Loader Adaptor Plate
Lift Sling Kit	Optional	Optional	Optional
Electronic Acre Meter	Optional	Optional	Optional
Brush Agitator Kit	Optional	Optional	Optional
Turf Maker Sprockets	Optional	Optional	Optional
Horsepower Requirements	35 HP (26.88 kW) and up	35 HP (26.88 kW) and up	35 HP (26.88 kW) and up
Recommended Operating Speed	3 to 5 MPH (5 to 8.3 km/h)	3 to 5 MPH (5 to 8.3 km/h)	3 to 5 MPH (5 to 8.3 km/h)

Document Control Revision Log:

Date	Revision	Improvement(s) Description and Comments
05/2008	102rev0508	Initial Release
10/2011	102rev1011	Updated, Incorporated Landoll Format
03/13/2013	102rev0313	Added New Acre Meter Data



Intertek

Equipment from Landoll Corporation is built to exacting standards ensured by ISO 9001 registration at all Landoll manufacturing facilities.

Landscape Grass Seeder Models LSP5, LSP6 and LSS6 Operator's Manual

Re-Order Part Number 7K458

LANDOLL CORPORATION

1900 North Street

Marysville, Kansas 66508

(785) 562-5381

800-428-5655 ~ WWW.LANDOLL.COM



Copyright 2013. Landoll Corporation

"All rights reserved, including the right to reproduce this material or portions thereof in any form."